



Mobile Modular Management Corporation
 1100 State Hwy 559
 Auburndale, FL 33823-9356
 Phone: (863) 965-3700
 Fax: (863) 965-7814
 www.mobilemodular.com

Sale Quotation and Agreement

Quotation Number: 240863
 Customer PO/Ref:
 Date of Quote: 03/27/2019

Sign up for the Easy Sale Option (see end of document for details)

Customer Information	Site Information	Mobile Modular Contact
Santa Rosa County School District 6544 Firehouse Rd Administrative Services Milton, FL 32570 Rufus Phillips phillipsr@santarosa.k12.fl.us Phone: (850) 607-4559	Santa Rosa County School District Santa Rosa Adult High 5697 Berryhill Road Milton, FL 32570 Rufus Phillips phillipsr@santarosa.k12.fl.us Phone: (850) 607-4559	Questions? Contact: Donna McBride Donna.McBride@mobilemodular.com Direct Phone: (352) 284-5753 Fax: (352) 475-1469

Product Information	Qty	Purchase Price	Extended Purchase Price	Taxable
Restroom, 12x30 DCA (Item1129) <i>Boy/Girl or Male/Female. Size excludes 4' towbar. No windows.</i>	1	\$72,900.00	\$72,900.00	N
Charges Upon Delivery	Qty	Charge Each	Total One Time	Taxable
Restroom, 12x30 DCA (Item1129)				
Block and Level Building (A5)	1	\$1,675.00	\$1,675.00	N
Delivery Haulage 12 wide	1	\$2,500.00	\$2,500.00	N
			<u>\$4,175.00</u>	
Total Estimated Charges				
		Subtotal	\$77,075.00	
		Taxes	\$0.00	
		Total Charges (including tax)	\$77,075.00	✓

Special Notes

Additional Note:

Pricing based on Mobile Modular's bid with Suwannee County Public Schools RFP #11-203. (Price Sheet July 1, 2018 , Attachment "C", Section 2 (Steel Frame Type IIB Buildings), Page 6, Item 15). Purchase Price 12x30 Mens/Womens Combo Restroom Building - Suwannee Bid \$84,801 - Santa Rosa County Quantity Discount \$72,900. Delivery Cost per 12x30 Restroom (based on an average of 450 miles) Suwannee Bid \$2,900.00 - Santa Rosa County Schools Quantity Discount \$2,500.00. Setup cost per Classroom: Suwannee Bid \$2,300 - Santa Rosa County Schools Quantity Discount \$1,675.

General: Customer's site must be dry, compacted, level and accessible by normal truck delivery. Pricing does not include any clearing or grading of sites, obstruction removal, site or final building clean up , any asphalt transitions, dolly, crane, forklift, electrical or plumbing connections, window coverings, furniture, casework, appliances, doorstops, phone or data lines, gutters, downspouts or tie-in, temporary power, temporary fencing, traffic control, flagmen, soil and/or pull test, custom engineering, fees associated with inspections, city or county submittals and/or use permits, security screens, door bars and any item not specifically listed as being included.

FL Not included in scope of work: Site architect services, building permits, site contracting not limited to sidewalks, grading, site preparation, utilities/connections, fire alarm systems, fire sprinkler systems.

Product Availability: Product availability and delivery date are subject to product availability upon receipt of Purchase Order, signed Agreement and/or credit approval.

Additional Note: Current estimated delivery time for this 12x30 newly manufactured group restroom unit would be middle to end of July 2019. Based on PO received week of April 1st.

FL Earth Anchors: This proposal assumes the use of earth anchoring on grass or dirt surface. Tie downs to asphalt, concrete or sugar sand may incur an additional fee.

FL Locate Responsibility: Customer is responsible for scheduling all locates (www.sunshine811.com) and making Mobile Modular aware of any hazards before digging.

Floor Plans

Sale Quotation and Agreement

Quotation Number: 240863

Customer PO/Ref:

Date of Quote: 03/27/2019



Restroom, 12x30 DCA (Item1129)

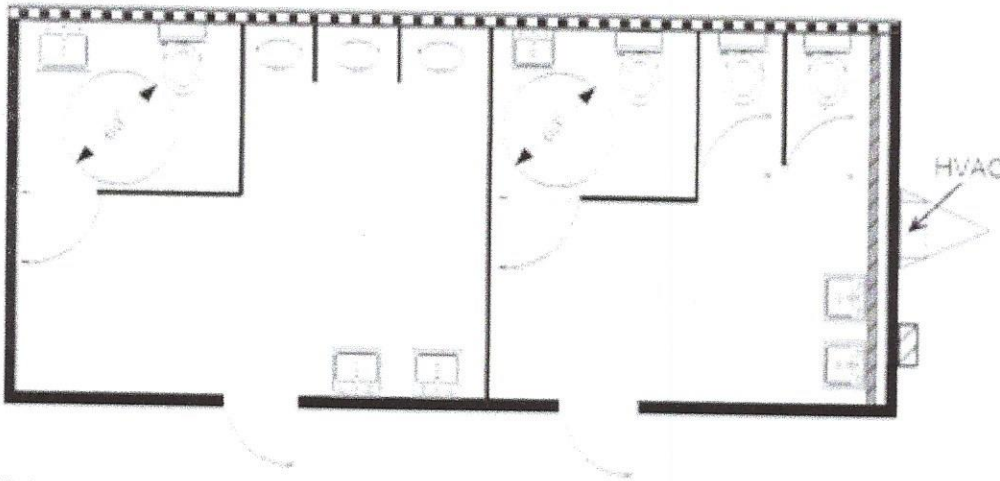

All drawings and specifications are nominal.

Additional Information

- Quote is valid for 30 days.
- Customer's site must be dry, compacted, level and accessible by normal truck delivery. Costs to dolly, crane, forklift, etc. will be paid by customer. Unless noted, prices do not include permits, stairs, foundation systems, temporary power, skirting, engineering, taxes or utility hookups.
- Subject to equipment availability. Unless noted, equipment and related furnishings, finishes, accessories and appliances provided are previously leased and materials, dimensions, and specifications vary. Detailed specifications may be available upon request.
- This transaction is subject to prior credit approval and all terms, conditions, and attachments of MMMC's standard contract.
- Down Payment required on execution.
- **Sales Tax will be calculated based on the tax rate at the time of invoicing.**
- **Unless otherwise noted, prices do not include prevailing wages, Davis-Bacon wages, or other special or certified wages.**

Thank you for contacting Mobile Modular.

Mobile Modular is a division of McGrath RentCorp.
240863, 03-27-2019 10:54 AM prod

Sale Quotation and Agreement

Quotation Number: 240863

Customer PO/Ref:

Date of Quote: 03/27/2019



Mobile Modular Easy Sale. Sign Me Up!

Getting your modular building on its way has never been easier... and faster. With Mobile Modular Easy Sale you can convert your Sale Quotation directly into a Sale Agreement by signing below. Once we receive your signed Easy Sale option, we'll finalize your building details and get your project on its way.

Review and acknowledge agreement.

This Quotation is subject to Mobile Modular Management Corporation, a California corporation, herein known as seller (the "Seller"), credit approval of Customer, herein known as buyer (the "Buyer"). Seller does not warrant that the equipment meets any local or state code not specifically listed herein. Equipment is subject to availability. By signing below, customer accepts the terms of this quotation including prices and specifications, and instructs Seller to make appropriate arrangements for the preparation and delivery of the Equipment identified herein, and agrees that such signature constitutes customer's acceptance of and agreement to the Seller's Sale Agreement. Such sale, and customer's agreement thereto, is subject to Seller's standard terms and conditions located on the Seller's web site at (www.mobilemodular.com/contractterms) which are incorporated by reference herein. Customer may request a copy of the terms and conditions from Seller. No alterations, additions, exceptions, or changes to any Quotation or Agreement made by Buyer shall be effective against Seller, whether made hereon, contained in any printed form of Sale or elsewhere, unless accepted in writing by Seller. Any customer purchase order or other customer-provided document purporting to replace, supersede or supplement the terms and conditions of the Seller's Sale Agreement shall carry no force or effect except as an instrument of billing.

Seller:

Mobile Modular Management Corporation

By: _____

Name: _____

Title: _____

Date: _____

Buyer:

Santa Rosa County School District

Signature: _____

Print Name: _____

Title: _____

Date: _____

Thank you for contacting Mobile Modular.

Mobile Modular is a division of McGrath RentCorp.
240863, 03-27-2019 10:54 AM prod

12' x 30' Restroom Building

