

13833 S ALABAMA ST,
JAY, FL 32565

FOR THE
SCHOOL BOARD OF
SANTA ROSA COUNTY

PHASE II
CONSTRUCTION DOCUMENTS

PROJECT INDEX:

<u>GENERAL</u>		<u>MECHANICAL SHEETS</u>	
A000	Set Cover Sheet - Project Stats. Sheet Index. Design Team.	M001	Mechanical Notes, Legend, and Abbreviations
		M002	Mechanical Schedules
<u>CIVIL</u>		M003	Mechanical Schedules
		M004	Mechanical Schedules
C000	Notes & Information	M101	Mechanical Plan
C001	Existing Site Conditions	M101	Mechanical Details
C002	Site Demolition Plan	M101	Mechanical Details
C003	Site Improvements Plan	M302	Mechanical Details
C004	Site Paving Plan	M303	Mechanical Details
C005	Site Dimensioning Plan	M304	Mechanical Details
C006	Site Grading Plan	M305	Mechanical Details
C007	Site Storm Water & Utility Plan	M306	Mechanical Details
C008	Miscellaneous Site Construction Details	M307	Mechanical Details
C009	Site Storm Water & Utility Details	M401	Mechanical Controls
C010	Site Storm Water & Utility Details	M402	Mechanical Controls
C011	Site Erosion Control Details	M403	Mechanical Controls
<u>STRUCTURAL</u>		<u>ELECTRICAL SHEETS</u>	
S001	General Notes & Typical Details	E001	Electrical Legend, Notes, and Abbreviations
S101	Foundation Plan	E100	Electrical Site Plan
S102	Floor Framing Plan	E200	Electrical Lighting Plan
S201	Sections & Details	E210	Electrical Power Plan
S301	Sections & Details	E220	Mechanical Power Plan
		E230	Electrical Systems Plan
		E301	Electrical Details
		E401	Electrical Single Line Diagram
		E402	Electrical Single Line Diagram
		E403	Electrical Panel Schedules
<u>ARCHITECTURAL SHEETS</u>			
A010	Abbreviations, Mounting Heights & Accessories Sched., Symbols		
A100	Life Safety Plan (600 Wing) / Code: Data		
A100	Construction Access Site Plan		
A101	Floor Plan		
A101.1	Dimension Floor Plan		
A101.2	Reflected Ceiling Plan		
A101.3	Roof Plan		
A101.4	Signage and Finish Plan		
A201	Exterior Elevations		
A301	Building Sections		
A310	Wall Sections		
A311	Wall Sections		
A331	Details		
A501	Door and Frame Schedule, Door, Frame and Window Types, Room Finish Schedule		
A502	Door and Frame Details and Window Details		
A601	Interior Elevations		
A611	Casework Details		
A612	Casework Details		
<u>PLUMBING SHEETS</u>		<u>FLORIDA PRODUCT APPROVAL NUMBERS</u>	
P001	Plumbing Notes, Legend, and Abbreviations	PRODUCT MANUFACTURER	ITEM
P002	Plumbing Schedules	STEEL PANT-IN SERIES	EXTERIOR HOLLOW METAL DOORS
P101	Sanitary and Vent Plan		STATE
P102	Domestic Water Plan		FL-1240
P301	Plumbing Plan	BERPDE	STANDING SEAM METAL ROOFING SYSTEM
P302	Plumbing Details	GREENECKA	EXTERIOR COVERS
F401	Riser Diagram and Details	WING	WINDOVS - SLIDERS 3410
			STATE
			FL-2286

B4	Project Sheet Index
SCALE NTS	

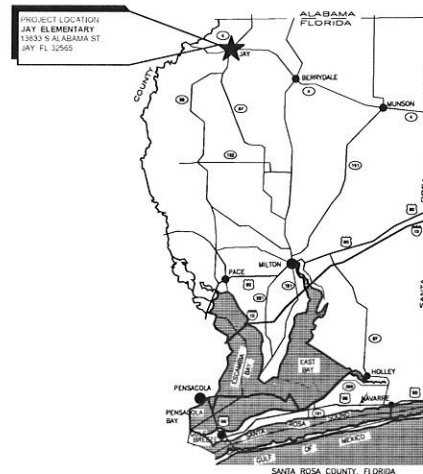

A4	Vicinity Map
SCALE NTS	



INTERPRETATION OF INSTRUMENTS OF SERVICE
ALL REPORTS, PLANS, SPECIFICATIONS, COMPUTATIONS, FIELD DATA, NOTES AND OTHER DOCUMENTS AND INSTRUMENTS PREPARED BY THE CONSULTANT AS INSTRUMENTS OF SERVICE SHALL REMAIN THE PROPERTY OF THE CONSULTANT. THE CONSULTANT SHALL RETAIN ALL COMMON LAW STATUTORY AND OTHER PRESERVED RIGHTS INCLUDING THE COPYRIGHT THEREIN.

CONSTRUCTION
DOCUMENTS
(PHASE III)

**Jay Elementary
Classroom Addition**
13833 S Alabama St,
Jay, FL 32565

Revision		
Date	No.	Description
Drawn By: JC		
Checked By: OEG		
Date:	08-06-18	
Project No.	17052	
Drawing Title Set Cover Sheet - Project Stats, Code Review, Sheet Index & Design Team		
Drawing No. A-000		

GENERAL NOTES

1. THE CONTRACTOR IS RESPONSIBLE FOR PROVIDING THE ENGINEER WITH A SIGNED AND SEALED SURVEY AS-BUILT DRAWING AT THE END OF CONSTRUCTION. SURVEY MUST INCLUDE DETAILED TOPOGRAPHY AND IDENTIFICATION OF ALL ON-GRADE FEATURES; TOP, BOTTOM, AND INVERT ELEVATIONS OF ALL STORM WATER AND SANITARY SEWER STRUCTURES, INCLUDING CLEANOUTS; STORM AND SANITARY PIPE ROUTING AND PIPE SIZES; AND APPROXIMATE LOCATIONS OF UNDERGROUND UTILITIES BASED ON REDLINE MARKUPS TO BE PROVIDED BY THE CONTRACTOR (LABELLED/NOTED AS "APPROXIMATE", "PER CONTRACTOR REDLINE", OR SIMILAR AT THE DISCRETION OF THE SURVEYOR OF RECORD).
2. ALL DISTURBED AREAS (NOT PAVED) TO BE STABILIZED WITH SOG.
3. ALL LANDSCAPE AND SOG/GRASS AREAS MUST BE FULLY IRRIGATED.
4. TREES NOT BEING REMOVED MUST BE PROTECTED PER DETAILS PRESENTED IN THE PLANS.
5. ALL TREE PROTECTION BARRICADES MUST BE PLACED PRIOR TO COMMENCEMENT OF ANY SITE WORK, INCLUDING LAND CLEARING, AND MUST BE MAINTAINED FOR THE DURATION OF THE PROJECT.
6. ALL SITE DRAINAGE INCLUDING ROOF DRAINS, DOWN SPOUTS, OR GUTTERS ARE TO BE ROUTED TO CARRY ALL STORM WATER TO THE PROPOSED STORM WATER MANAGEMENT SYSTEM.
7. THE LOCATIONS OF KNOWN UNDERGROUND UTILITIES ARE SHOWN IN AN APPROXIMATE WAY ONLY AND HAVE NOT BEEN INDEPENDENTLY VERIFIED. THE CONTRACTOR MUST DETERMINE THE EXACT LOCATION OF ALL EXISTING UTILITIES BEFORE COMMENCING WORK AND AGREES TO BE FULLY RESPONSIBLE FOR ANY AND ALL DAMAGES WHICH MIGHT BE OCCASIONED BY THE CONTRACTOR'S FAILURE TO EXACTLY LOCATE AND PRESERVE ANY AND ALL UNDERGROUND UTILITIES.
8. CONTRACTOR IS RESPONSIBLE FOR INSTALLATION, PRIOR TO CONSTRUCTION, AND MAINTENANCE/REPAIRS, DURING CONSTRUCTION, OF SEDIMENT AND EROSION CONTROL MEASURES AS REQUIRED TO RETAIN ALL SEDIMENT AND EROSION ON THE SITE OF DEVELOPMENT. THE PROVISIONS AS SHOWN ON THESE PLANS REPRESENT THE MINIMUM EROSION CONTROL MEASURES TO BE TAKEN, AND CONTRACTOR IS RESPONSIBLE FOR INCLUDING ANY ADDITIONALLY REQUIRED MEASURES IN HIS BASE BID OR FOR PROVIDING ADDITIONAL MEASURES AS NECESSARY AT NO ADDITIONAL COST TO THE OWNER DURING CONSTRUCTION. IMPROPER SEDIMENT CONTROL MEASURES MAY RESULT IN CODE ENFORCEMENT VIOLATION.
9. ALL ASPECTS OF THE STORM WATER/DRAINAGE COMPONENTS AND/OR TRANSPORTATION COMPONENTS MUST BE COMPLETED PRIOR TO ISSUANCE OF A FINAL CERTIFICATE OF OCCUPANCY.
10. CONTRACTOR MUST RESHAPE PER PLAN SPECIFICATIONS, CLEAN OUT ACCUMULATED SILT, AND STABILIZE RETENTION/DETENTION POND(S) AND ADJACENT ROADSIDE DITCH SYSTEMS AT END OF CONSTRUCTION WHEN ALL DISTURBED AREAS HAVE BEEN STABILIZED.
11. ANY DAMAGE TO EXISTING ROADS DURING CONSTRUCTION WILL BE REPAIRED BY THE CONTRACTOR PRIOR TO FINAL "AS-BUILT" SIGN-OFF FROM THE COUNTY.
12. THE OWNER OR HIS AGENT MUST ARRANGE/SCHEDULE WITH THE COUNTY A FINAL INSPECTION OF THE DEVELOPMENT UPON COMPLETION AND ANY INTERMEDIATE INSPECTIONS. AS-BUILT CERTIFICATION IS REQUIRED PRIOR TO REQUEST FOR FINAL APPROVAL.
13. THIS PROJECT MUST BE BUILT IN ONE PHASE.
14. NOTIFY SUNSHINE UTILITIES 48 HOURS IN ADVANCE PRIOR TO DIGGING WITHIN R/W. 811.
15. NO DEVIATIONS OR REVISIONS FROM THESE PLANS BY THE CONTRACTOR WILL BE ALLOWED WITHOUT PRIOR WRITTEN APPROVAL FROM THE DESIGN ENGINEER AND NOTIFICATION OF COUNTY ENGINEERING. ANY DEVIATIONS MAY RESULT IN DELAYS IN OBTAINING A CERTIFICATE OF OCCUPANCY.
16. THE CONTRACTOR MUST COMPLY WITH ALL FEDERAL AND STATE REGULATIONS CONCERNING NOTIFICATION TO THE REGULATORY AUTHORITIES OF ANY AND ALL BUILDING RENOVATIONS AND/OR DEMOLITION.
17. CONTRACTOR MUST PROTECT EXISTING AND RELOCATED SIGNS IN THE RIGHT-OF-WAY. CONTRACTOR MUST REPLACE DAMAGED SIGNS AND/OR POST IF DAMAGE OCCURS DURING CONSTRUCTION ACTIVITIES.
18. IT IS THE CONTRACTOR'S RESPONSIBILITY TO PROTECT ALL BENCHMARKS DURING CONSTRUCTION, INCLUDING ALL PUBLIC AND PRIVATE LAND CORNER MONUMENTATION. IF A PUBLIC OR PRIVATE CORNER IS IN DANGER OF BEING DISTURBED AND HAS NOT BEEN PROPERLY REFERENCED, THE CONTRACTOR MUST NOTIFY THE ENGINEER OF RECORD IMMEDIATELY. IF ANY MONUMENT IS DISTURBED OR DESTROYED THE CONTRACTOR WILL BE RESPONSIBLE FOR REPLACEMENT OF THE MONUMENT AT A LOCATION DETERMINED BY A FLORIDA LICENSED PROFESSIONAL SURVEYOR AND MAPPER USING GUIDELINES AS ESTABLISHED BY NATIONAL GEODETIC SURVEY FOR BLUE BOOKING AND APPROVAL.

SITE DATA SUMMARY

PROP. REF. NO. 19-5N-29-0000-06900-0000

PARCEL AREA 39.01 ACRE (1,699,276 SF)

STREET ADDRESS 4949 ALABAMA ST.
JAY, FLORIDA 32565

CURRENT USE PUBLIC SCHOOL

ZONING MIX: CITY & P2 (ACTIVE PARK)

SETBACKS FRONT: TBD
BACK: TBD
SIDE: TBD

STORMWATER PROJECT AREA 100775 SF (100%)

EXISTING PERVIOUS 70030 SF (69%)
IMPERVIOUS 30745 SF (31%)
BUILDING, MISC. 00000 SF (0%)

PROPOSED PERVIOUS 70204 SF (70%)
IMPERVIOUS 18014 SF (18%)
BUILDING, MISC. 12557 SF (12%)

FLOOD ZONE THE PARCEL SHOWN IS LOCATED WITHIN THE FOLLOWING FLOOD ZONE(S) AS DETAILED BY FEMA FIRM (FLOOD INSURANCE RATE MAP) INFORMATION DESCRIBED BELOW:

FLOOD ZONE (S)	NFP COMMUNITY NUMBER*	PANEL NUMBER*	MAP SUFFIX*	MAP REVISION DATE*
X	120339	12113C	0035	G DECEMBER 19, 2006

TREE INFORMATION

TREE SCHEDULE			
TREE #	SPECIES	CANOPY	DIAMETER
2101	OAK	60'	28"
2102	OAK	60'	30"
2103	OAK	15'	15"
2104	PINE	25'	24"
2105	CREPE MYRTLE CLUSTER	5'	4"
2106	CREPE MYRTLE CLUSTER	5'	4"
2107	CREPE MYRTLE CLUSTER	5'	4"
2108	CREPE MYRTLE CLUSTER	5'	4"
2109	CREPE MYRTLE CLUSTER	5'	4"
2287	PECAN	40'	30"
2288	OAK	60'	60"
3234	PINE	60'	28"
3235	PINE	40'	28"
3236	OAK	65'	36"
3237	HICKORY	50'	28"
3238	OAK	50'	30"
3239	OAK	30'	32"
3240	OAK	30'	32"
3241	OAK	80'	36"
4184	MAGNOLIA	40'	15"

UTILITY COMPANIES

CABLE TELEVISION -
BRIGHT HOUSE NETWORKS
240 S HWY 97
CANTONMENT, FLORIDA
(850) 968-0399 X4720

ELECTRIC -
ESCAMBA RIVER ELECTRIC CO-OP, INC.
3425 FL-4
JAY, FLORIDA
(850) 675-7439

GAS -
GENESIS PIPELINE, USA
(251) 298-1439

NATURAL GAS -
GULF SOUTH PIPELINE CO LP
480 VAN PELT LANE
PENSACOLA, FLORIDA
(850) 484-0354

SANITARY SEWER / POTABLE WATER -
TOWN OF JAY
(850) 675-4556

TELEPHONE -
AT&T DISTRIBUTION
(561) 997-0240

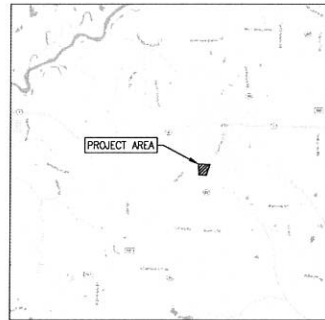

VICINITY MAP
SECTION 6, TOWNSHIP 2-S, RANGE 29-N
PROPERTY OWNER
TIM WYROSZICK, SUPERINTENDENT
SANTA ROSA COUNTY SCHOOL BOARD
5086 CANAL ST
MILTON, FL 32570
DEVELOPER / PROJECT OWNER
JOEY HARRELL, ASST Supt FOR ADMIN SVCS
SANTA ROSA COUNTY SCHOOL BOARD
6544 FIREHOUSE ROAD
MILTON, FL 32570

Sheet List Table

Sheet Number	Sheet Title
C000	NOTES AND INFORMATION
C001	EXISTING SITE CONDITIONS
C002	SITE DEMOLITION PLAN
C003	SITE IMPROVEMENTS PLAN
C004	PHASING PLAN
C005	SITE DIMENSIONING PLAN
C006	SITE GRADING PLAN
C007	SITE STORM WATER & UTILITY PLAN
C008	MISCELLANEOUS SITE CONSTRUCTION DETAILS
C009	SITE STORM WATER & UTILITY DETAILS
C010	SITE STORM WATER & UTILITY DETAILS
C011	SITE EROSION CONTROL DETAILS

NOTES AND INFORMATION

LEGEND:

FOUND 4"x4" CONCRETE MONUMENT (FDO)	CONCRETE AREAS
SET BENCHMARK	COVERED CONCRETE AREAS
CHAIN LINK FENCE	A/C AIR CONDITIONER
CHAIN LINK FENCE WITH VISION SLATS	APPX. APPROXIMATE LOCATION OF
OVERHEAD UTILITIES	BFP BACKFLOW PREVENTOR
BURIED WATER LINE	BOC BACK OF CURB
BURIED ELECTRIC LINE	BM BENCHMARK
BURIED TELEPHONE LINE	CLF CHAIN LINK FENCE
BURIED FIBER OPTIC CABLE	CWP CORRUGATED METAL PIPE
GUARD RAIL	CONC CONCRETE
LANDSCAPING AREA	CPP CORRUGATED PLASTIC PIPE
SURVEY LIMITS	DIP DUCTILE IRON PIPE
SOLID WHITE PAINT LINE	EOP EDGE OF PAVEMENT
SOLID YELLOW PAINT LINE	EL ELEVATION
SOLID BLUE PAINT LINE	ERCP ELLIPTICAL REINFORCED
DOUBLE YELLOW PAINT LINE	CONCRETE PIPE
FLOW LINE	FFE FINISHED FLOOR ELEVATION
STORMWATER MANHOLE	FDO FLORIDA DEPARTMENT OF
DROP INLET	TRANSPORTATION
ADS YARD INLET	GSP GALVANIZED STEEL PIPE
WATER METER	INV INVERT
WATER VALVE	LSA LANDSCAPING AREA
FIRE HYDRANT	MES MITERED END SECTION
FIRE DEPARTMENT CONNECTION	NAVD 88 NORTH AMERICAN VERTICAL
DOWNSPOUT	DATUM 1988
SEWER MANHOLE	PVC POLYVINYL CHLORIDE PIPE
CLEANOUT	RCP REINFORCED CONCRETE PIPE
SEWER VALVE	R/W RIGHT-OF-WAY
ELECTRIC BOX	S/W SIDEWALK
ELECTRIC METER	(TYP) TYPICAL FEATURE
ELECTRIC VAULT	TREE LEGEND
ELECTRICAL MARKER	OAK
ELECTRIC PANEL	PINE
GAS METER	CREPE MYRTLE CLUSTER
GAS REGULATOR	HICKORY
BURIED FIBER OPTIC CABLE MARKER	MAGNOLIA
TELEPHONE VAULT	PECAN
COMMUNICATIONS VAULT	
TELEPHONE PULL BOX	
TELEPHONE PEDESTAL	
FIBER OPTIC CABLE WIRE PULL BOX	
FIRE ALARM WIRE PULL BOX	
WALL MOUNT AIR CONDITIONER	
GUY WIRE ANCHOR	
WOOD UTILITY POLE	
LIGHT POLE	
FLAG POLE	
MEMORIAL STONE	
UTILITY SPOT LOCATION	
BOLLARD	
6" ROUND AWNING SUPPORT POLE	
3" SQUARE AWNING SUPPORT POLE	
4" SQUARE AWNING SUPPORT POLE	
4" ROUND AWNING SUPPORT POLE	
SINGLE SUPPORT SIGN	
RADIO MAST	
DETECTABLE WARNING PAD	
PICNIC TABLE	
WIRE PULL BOX	
SPOT ELEVATION	
ELEVATION CONTOUR LINE AT ONE FOOT INTERVALS	

jhi jehe-halstead inc.
Civil Engineering and Surveying
10000 N. US HWY 90, SUITE 100
MILTON, FL 32570
www.jhiinc.com
Certified Professional Engineer, State of Florida
Surveying License Number 12158



DAVID M. JEHLE, JR.
P.E. 71528
10000 N. US HWY 90, SUITE 100
MILTON, FL 32570
TELEPHONE 850-426-0601 FAX 850-426-0601
JAY, FLORIDA

PROJECT NO. 19-5N-29-0000-06900-0000
SHEET NO. C000
DATE: AUGUST 1, 2018
PROJECT NO.: 170055

PHASE III

Jay Elementary
Classroom Addition
13833 S Alabama St.
Jay, FL 32565

D. PATRICK JEHE, JR.
P.E. 71528

Revision	Date	By	Notes

Drawn By: ASM
Checked By: DPJ

Date: August 1, 2018

Project No.: 170055

Drawing Title:

NOTES AND INFORMATION

Drawing No.: C000

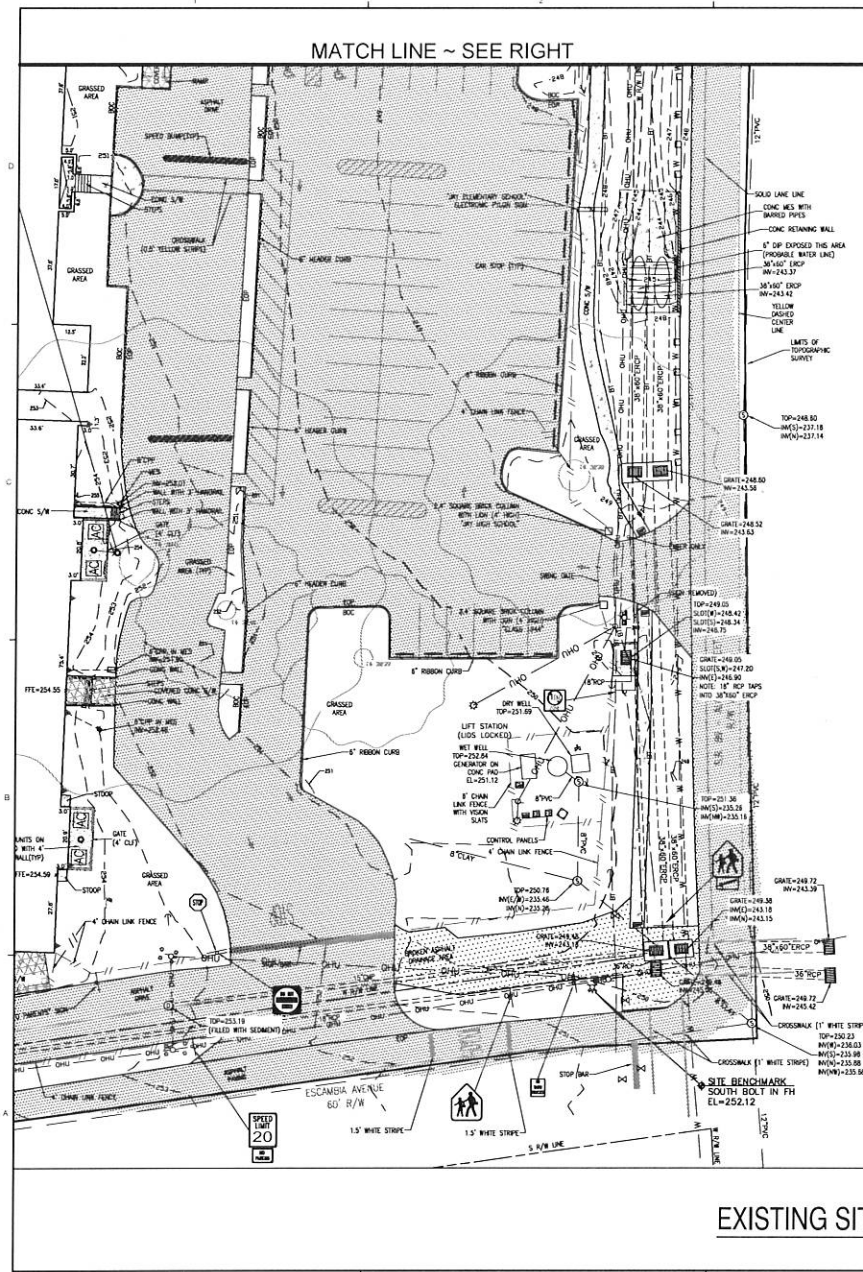

SURVEYOR'S NOTES (JEHLE-HALSTEAD, INC. JOB# 170055, DATED 08/28/17):

- 1.....DISTANCES ARE BASED ON U.S. STANDARD FOOT.
- 2.....REFERENCES USED: EXISTING FIELD MONUMENTATION, SURVEY PREPARED BY SOUTHERN SURVEYING, DATED 7/17/08. PREVIOUS SURVEY PREPARED BY THIS FIRM, JOB #000004.5000.
- 3.....ELEVATIONS ARE BASED ON NATIONAL GEODETIC SURVEY BENCHMARK SANTA, HAVING A PUBLISHED ELEVATION OF 239.43 NORTH AMERICAN VERTICAL DATUM OF 1988.
- 4.....THE SURVEYING BUSINESS CERTIFICATE OF AUTHORIZATION NUMBER FOR JEHL-HALSTEAD, INC. IS LB. 7483.
- 5.....ONLY TREES 12" DIAMETER OR GREATER WERE LOCATED ON THIS SURVEY.

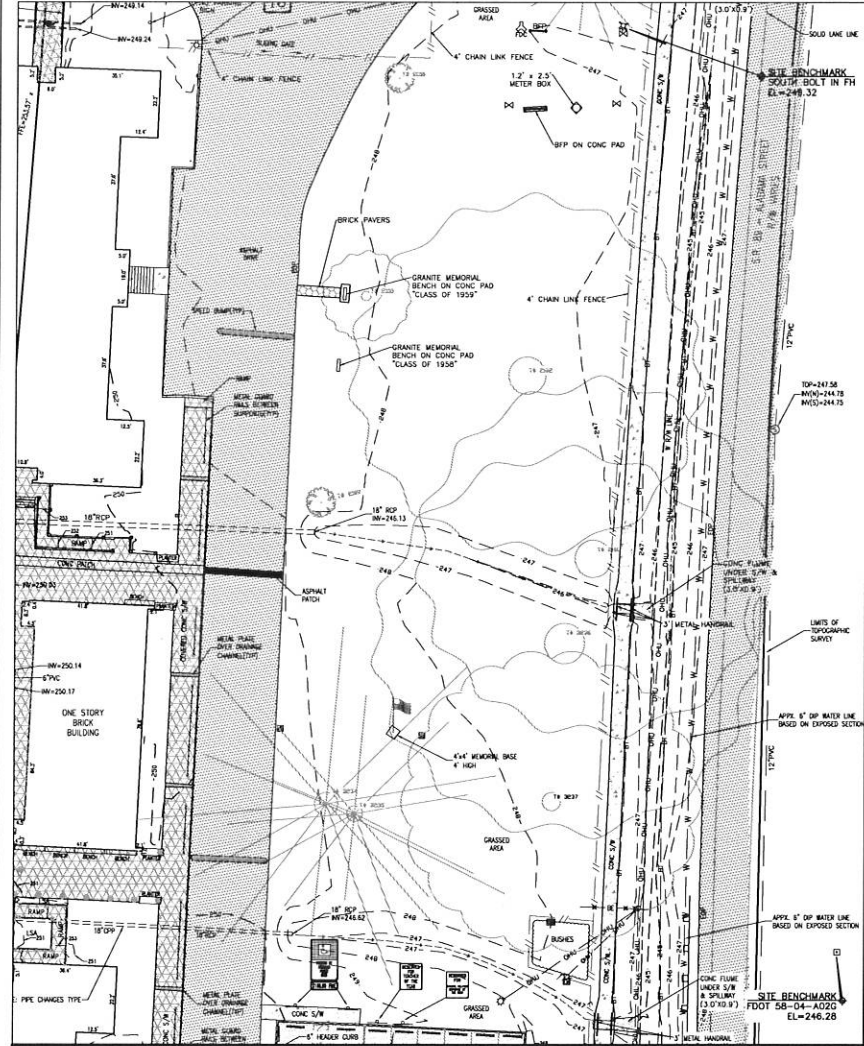

0' 10' 20' 40'
SCALE IN FEET

jhi jehle-halstead inc.
Civil Engineering and Surveying
10416 Rutledge Street - Jacksonville, Florida 32216
(904) 748-9400
www.jehle-halstead.com
Certified Professional Surveyor No. 33334
Surveying License Number 27801



ALL REPORTS, PLANS, SPECIFICATIONS, AND CALCULATIONS PREPARED BY THIS FIRM ARE THE PROPERTY OF THE CONSULTANT. THE CONSULTANT SHALL NOT BE RESPONSIBLE FOR THE ACCURACY OF ANY INFORMATION PROVIDED BY OTHER SOURCES. THE CONSULTANT SHALL NOT BE RESPONSIBLE FOR THE ACCURACY OF ANY INFORMATION PROVIDED BY OTHER SOURCES.

PHASE III

**Jay Elementary
Classroom Addition**
13833 S Alabama St.,
Jay, FL 32565

D. PATRICK JEHL, JR. P.E. 71528	
Revision	
1	1/1/2018
2	
3	
4	
5	
6	
7	
8	
9	
10	
11	
12	
13	
14	
15	
16	
17	
18	
19	
20	
21	
22	
23	
24	
25	
26	
27	
28	
29	
30	
31	
32	
33	
34	
35	
36	
37	
38	
39	
40	
41	
42	
43	
44	
45	
46	
47	
48	
49	
50	
51	
52	
53	
54	
55	
56	
57	
58	
59	
60	
61	
62	
63	
64	
65	
66	
67	
68	
69	
70	
71	
72	
73	
74	
75	
76	
77	
78	
79	
80	
81	
82	
83	
84	
85	
86	
87	
88	
89	
90	
91	
92	
93	
94	
95	
96	
97	
98	
99	
100	

Drawn By: ASM
Checked By: DPJ
Date: August 1, 2018
Project No.: 170055
Drawing Title: EXISTING SITE CONDITIONS
Drawing No.: C001

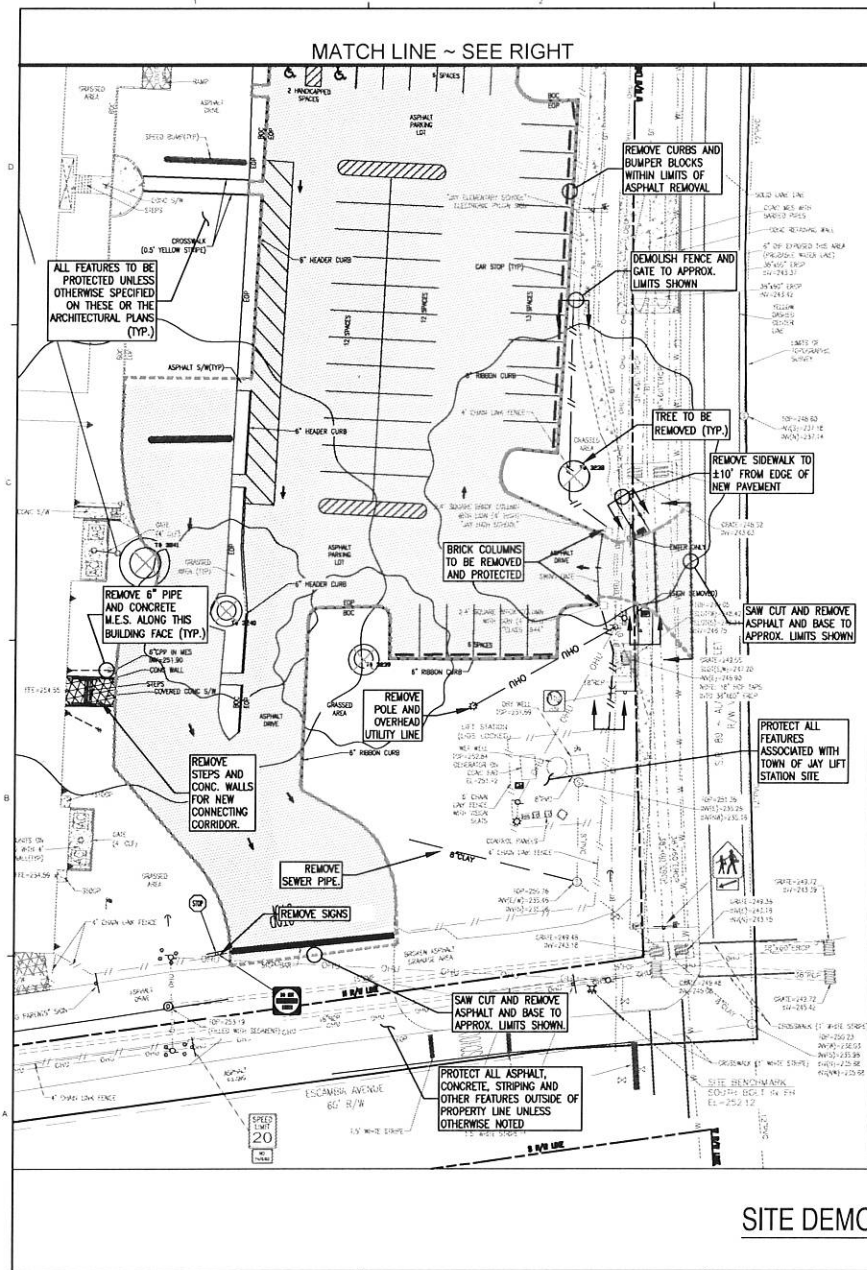

SITE DEMOLITION NOTES

1. SEE SHEET C000 FOR LEGEND

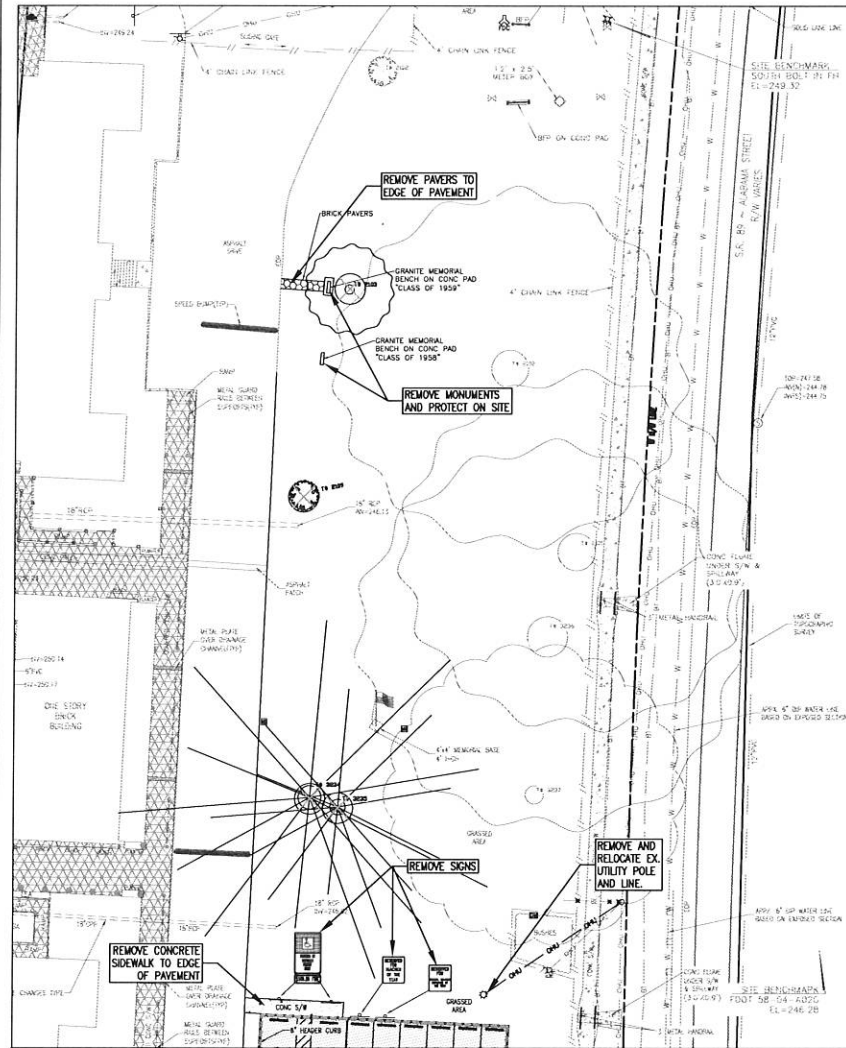

MATCH LINE ~ SEE LEFT

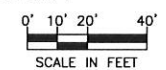

jhi jeffrey-halstead inc.
 Surveying and Engineering
 10000 N. W. 10th Ave.
 Suite 200
 Fort Lauderdale, FL 33309
 Phone: (954) 574-9400
 Fax: (954) 574-9401
 www.jhi-inc.com



DAVID A. GRIFFIN, P.E.
 10000 N. W. 10th Ave., Suite 200
 Fort Lauderdale, FL 33309
 Telephone: (954) 574-9401 Fax: (954) 574-9401
 Email: dag@daginc.com

DISCLAIMER:
 ALL INFORMATION CONTAINED HEREIN IS THE PROPERTY OF DAG INC. AND IS NOT TO BE REPRODUCED OR TRANSMITTED IN ANY FORM OR BY ANY MEANS, ELECTRONIC OR MECHANICAL, INCLUDING PHOTOCOPYING, RECORDING, OR BY ANY INFORMATION STORAGE AND RETRIEVAL SYSTEM, WITHOUT THE WRITTEN PERMISSION OF DAG INC.

PHASE III

Jay Elementary Classroom Addition 13833 S Alabama St. Jay, FL 32565

D. PATRICK JEHL, JR.
 P.E. 71528

Revision	Date	By	Check

Drawn By: ASM
 Checked By: DPJ

Date: August 1, 2018

Project No.: 170055

Drawing Title: SITE DEMOLITION PLAN

Drawing No.: C002

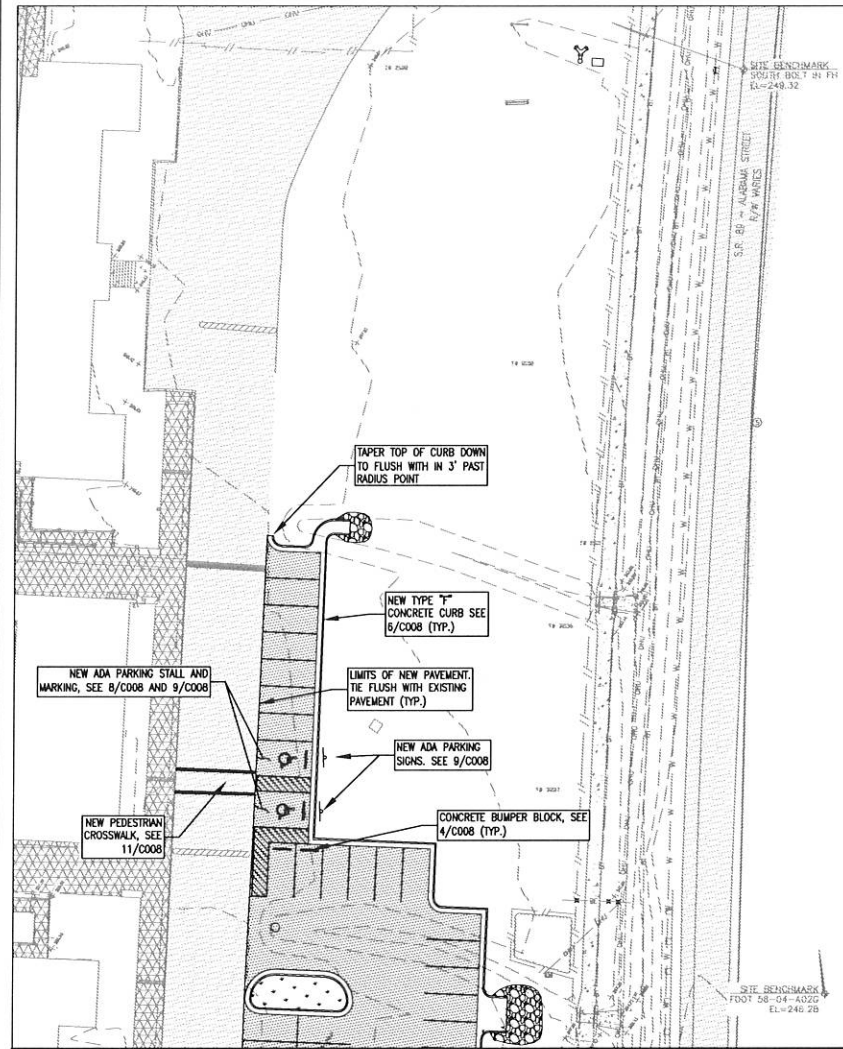
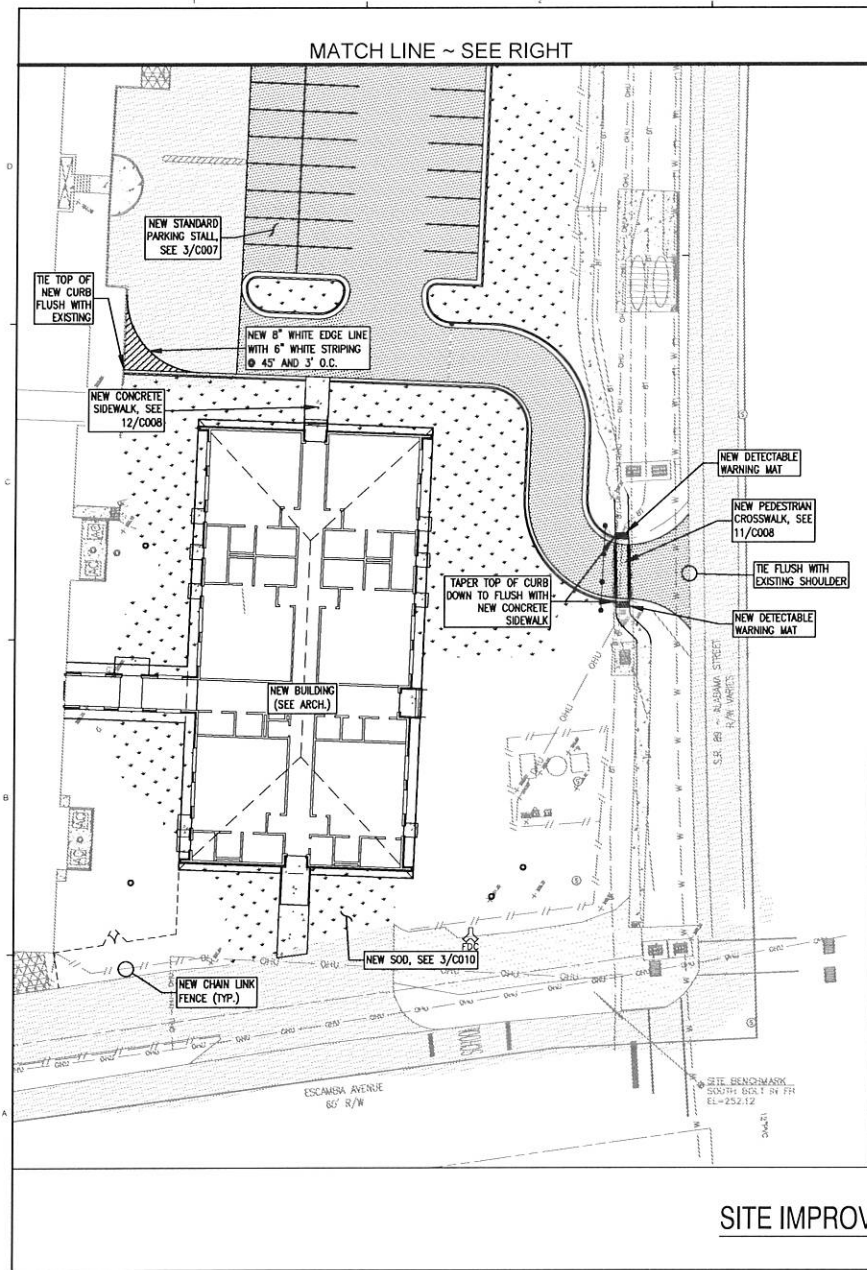

0' 10' 20' 40'
SCALE IN FEET



jhi jehe-halstead inc.
Civil Engineering and Surveying
12414 North Street, Suite 100, Fort Worth, TX 76134
(817) 785-9900
www.jhehe-halstead.com
Professional Engineer License No. 33346
Surveying License Number 12183



DATE: 10/11/17
BY: JPH/ADP/ELC - SEE 204
PROJECT: JAY EL. 1242
DRAWING: 170055 CLASSROOM ADDITION
PLAN 000743

DISCLAIMER: This drawing is prepared by JPH/ADP/ELC and is based on field data and information provided by the client. It is not intended to be used for any purpose other than the project for which it was prepared. The client is responsible for the accuracy and completeness of the information provided. The engineer is not responsible for the accuracy and completeness of the information provided.

PHASE III

Jay Elementary Classroom Addition

13833 S Alabama St,
Jay, FL 32565

D. PATRICK JEHE, JR.
P.E. 71528

Revision	By	Check	Date

Drawn By: ASM
Checked By: DPJ

Date: August 1, 2018

Project No.: 170055

Drawing Title:
SITE IMPROVEMENTS PLAN

Drawing No.: **C003**

PHASING PLAN

jhi **jehle-halstead inc.**
Civil Engineering and Surveying
11400 McPherson Street • Minneapolis, Minnesota 55426
(612) 234-0922
www.jhi-inc.com/jhi51301
Equal Opportunity Employer M/F/V (3034599)
Employment is subject to background check (P.108)

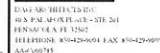

OWNERSHIP OF INSTRUMENTS OF SERVICE
ALL REPORTS, PLANS, SPECIFICATIONS, COMPUTER FILES, NOTES AND OTHER DOCUMENTS AND INSTRUMENTS PREPARED BY THE CONSULTANT AS INSTRUMENTS OF SERVICE SHALL REMAIN THE PROPERTY OF THE CONSULTANT. THE CONSULTANT SHALL NOT BE BOUND BY ANY STATUTE OR OTHER RESERVED RIGHTS INCLUDING THE COPYRIGHT THEREON.

PHASE III

**Jay Elementary
Classroom Addition**
13833 S Alabama St,
Jay, FL 32565

D. PATRICK JEHLE, JR.
P.E. 71528

[illegible]

Drawn By: ASM

Checked By: DPJj

Date: August 1, 201

Project No.: 170066

Drawing Title:

Drawing file:

PHASING

PLAN

Drawing No.: C004

[illegible]

1. ALL DIMENSIONS ARE GIVEN FROM THE EDGE OF ASPHALT PAVEMENT OR CONCRETE SIDEWALK UNLESS OTHERWISE NOTED.

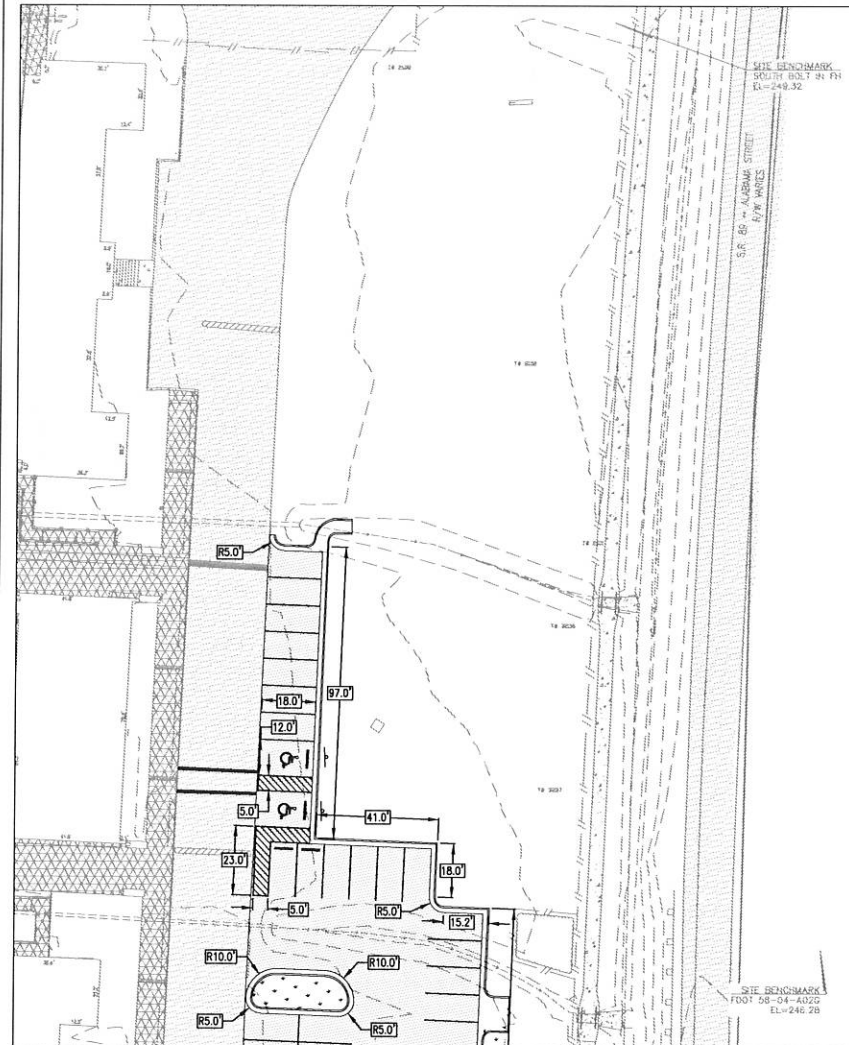

MATCH LINE ~ SEE LEFT



jhi jehle-halstead, inc.
Civil Engineering and Surveying
14141e Hardscrabble - Marietta, Georgia 30067
(404) 974-9502
www.jhi-halstead.com
Certificate of Authorization No. 00064597
Surveying License Number 127883

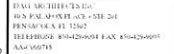

OWNERSHIP OF INSTRUMENTS OF SERVICE
ALL REPORTS, PLANS, SPECIFICATIONS, COMPUTERFILES, FIELD DATA, NOTES AND OTHER DOCUMENTS AND INSTRUMENTS PREPARED BY THE CONSULTANT AS INSTRUMENTS OF SERVICE SHALL REMAIN THE PROPERTY OF THE CONSULTANT. THE CONSULTANT SHALL RETAIN ALL COMMON LAW, STATUTORY AND OTHER RESERVED RIGHTS INCLUDING THE COPYRIGHT THEREIN.

**Jay Elementary
Classroom Addition**
13833 S Alabama St,
Jay, FL 32565

[illegible]

Date: August 1, 2018

Drawing Title:

Drawing No. C005

MATCH LINE ~ SEE RIGHT

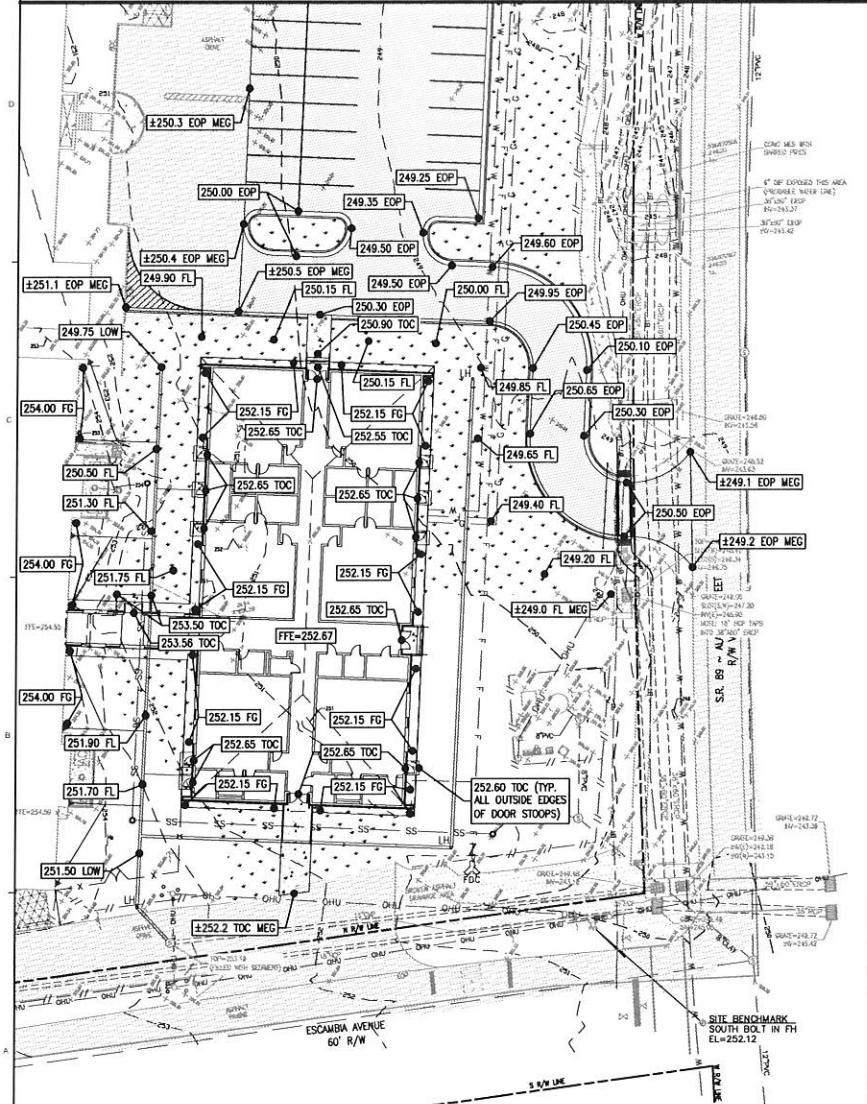

GRADING NOTES:

- THE FOLLOWING ABBREVIATIONS APPLY:
 EOP = EDGE OF PAVEMENT
 EOG = GRADE BREAK
 EOB = MATCH EXISTING GRADE
 EOC = TOP OF CONCRETE
 EOL = FLOW LINE
 EOM = HANDICAP ACCESSIBLE CRITICAL GRADE
 FG = FINAL GRADE (EXTERIOR)
 GBL = GRADE BREAK LINE
 TO = TOP OF CONCRETE
 HCA = HANDICAP ACCESSIBLE CRITICAL GRADE
- PROPOSED ELEVATIONS OF TOP OF CURB AND/OR SIDEWALK ARE 4" HIGHER THAN THE ADJACENT EDGE OF PAVEMENT GRADES UNLESS OTHERWISE SPECIFIED.
- CONTRACTOR IS RESPONSIBLE FOR GRADING SITE TO ACHIEVE PROPOSED SURFACE FLOW PATTERNS INDICATED BY PROPOSED SPOT ELEVATIONS AND CONTOURS. IN ALL CASES RUNOFF MUST BE DIRECTED AWAY FROM BUILDINGS, WALKS AND PADS.

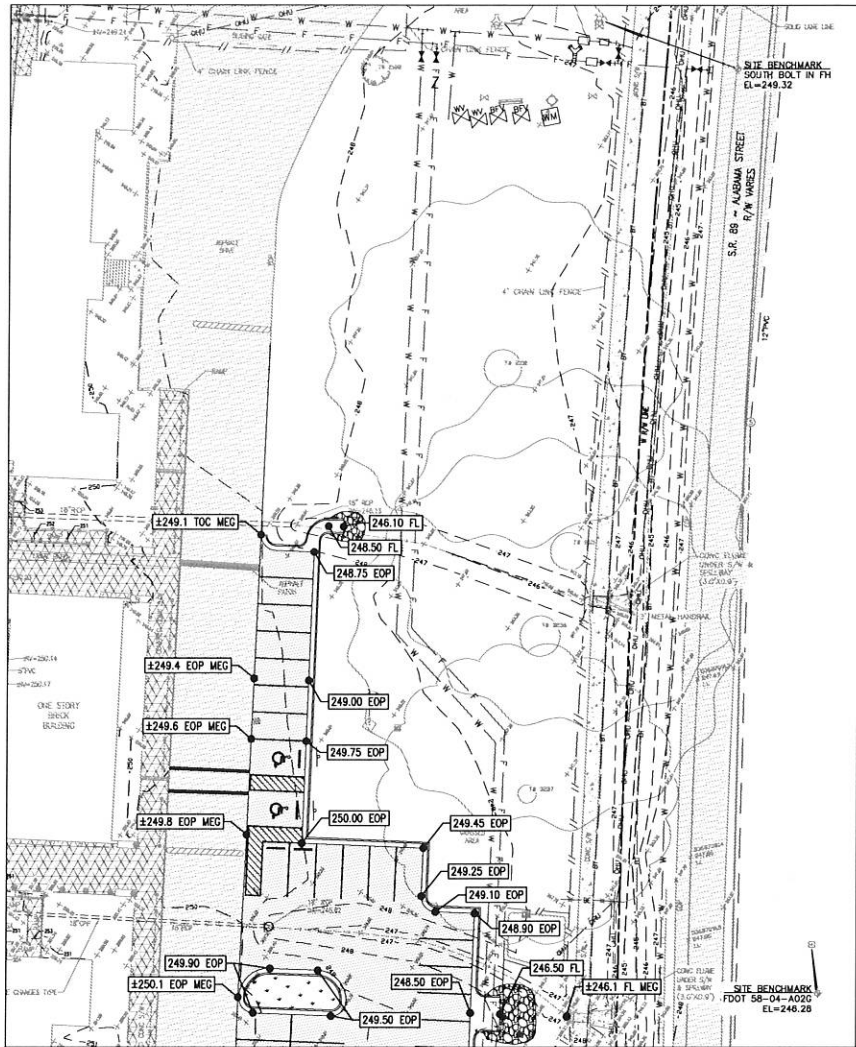

SITE GRADING PLAN

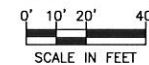

jhi jeffrey-halstead inc.
 Civil Engineering and Surveying
 10000 Highway 19 North, Suite 100, Jacksonville, FL 32256
 (904) 744-1000
 www.jeffrey-halstead.com
 Civil Engineer License No. 10000, Surveyor License No. 10000



10000 Highway 19 North, Suite 100, Jacksonville, FL 32256
 (904) 744-1000
 www.jeffrey-halstead.com
 Civil Engineer License No. 10000, Surveyor License No. 10000

PHASE III

Jay Elementary Classroom Addition
 13833 S Alabama St.,
 Jay, FL 32565

D. PATRICK JEHL, JR. P.E. 11538	
Revision	
Date	No. Description
Drawn By:	ASM
Checked By:	D.P.J.
Date:	August 1, 2018
Project No.:	170055
Drawing Title:	SITE GRADING PLAN
Drawing No.:	C006

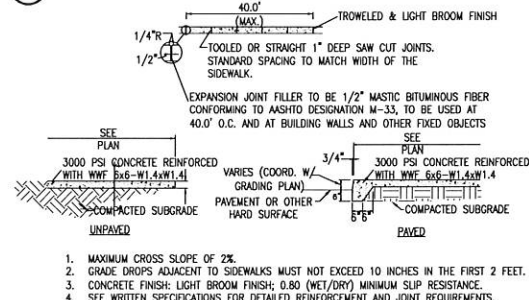
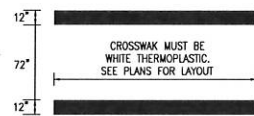
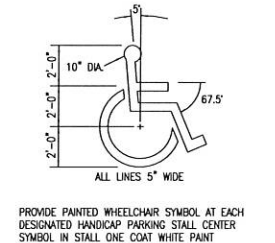
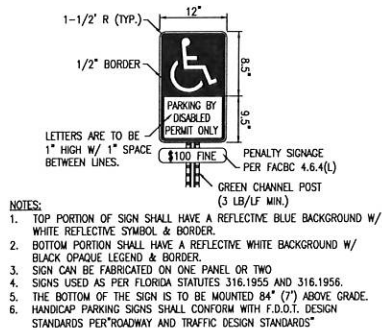
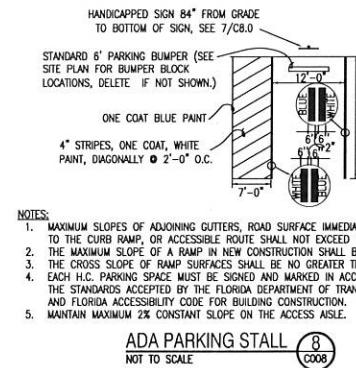
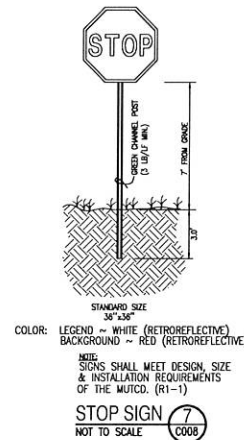
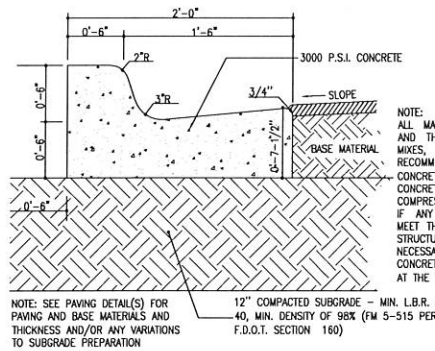
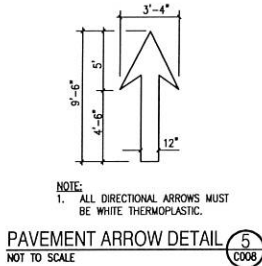
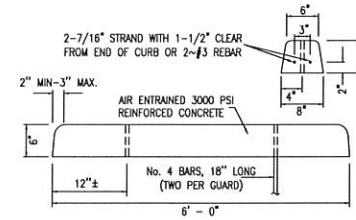
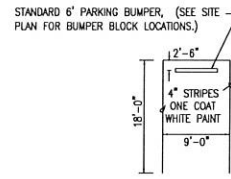
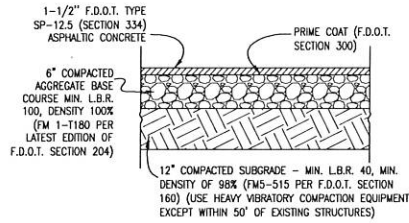
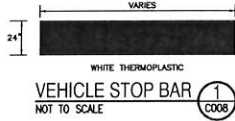

MISCELLANEOUS SITE CONSTRUCTION DETAILS

jhi jeble-halstead inc.
Civil Engineering and Surveying
12401 N. Highway 100, Suite 100
Dallas, Texas 75243
www.jhiinc.com
Contact: 214.340.1000 or 214.340.1001
Fax: 214.340.1002

dag

DAVID A. GRIFFIN, P.E.
DAVID A. GRIFFIN & ASSOCIATES, INC.
13833 S. ALABAMA ST., SUITE 204
JAY, FL 32565
ALBA 1007/15

ALL REPORTS, PLANS, SPECIFICATIONS, COMPUTERS, AND DATA
REQUIREMENTS SHALL BE IN ACCORDANCE WITH THE
LATEST EDITIONS OF THE STANDARD SPECIFICATIONS FOR
CONCRETE, ASPHALT, AND OTHER MATERIALS, AND THE
LATEST EDITIONS OF THE STANDARD SPECIFICATIONS FOR
BUILDING THE CONSTRUCTION OF THE STATE.

PHASE III

**Jay Elementary
Classroom Addition**
13833 S Alabama St.,
Jay, FL 32565

D. PATRICK JEHL, JR.
P.E. 71528

Revision	By	Check	Date

Drawn By: ASM
Checked By: DPJ

Date: August 1, 2018

Project No.: 170055

Drawing Title:
**MISC. SITE
CONSTRUCTION
DETAILS**

Drawing No.: **C008**

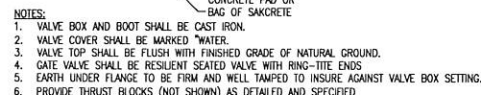

TAPPING SLEEVE AND VALVE (3)
NOT TO SCALE (C008)

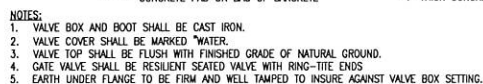
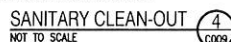

VALVE AND BOX (5)
NOT TO SCALE CD09

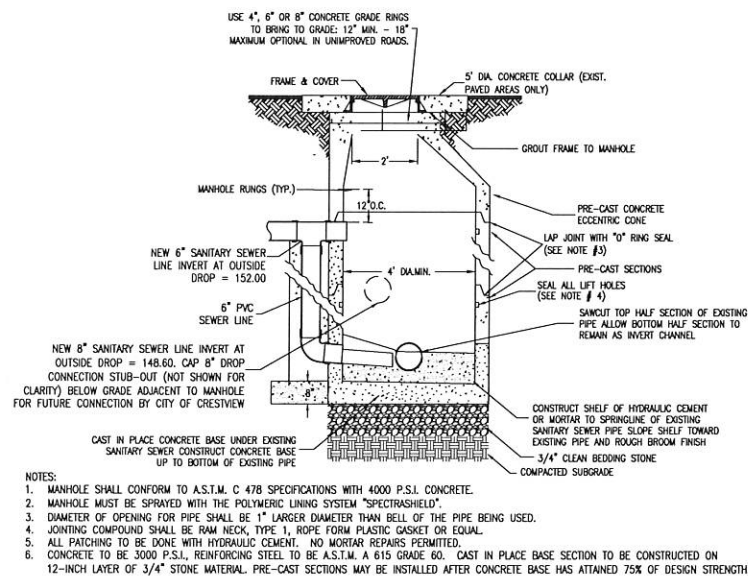

DOGHOUSE MANHOLE WITH EXTERNAL DROP CONNECTION DETAIL 6

jhi **jehle-halstead inc.**
Civil Engineering and Surveying
10000 Glenhurst Street • Port Huron, MI 48130
(810) 434-1922
www.jehle-halstead.com
E-mail: jehle@jehle-halstead.com
Fax: (810) 434-1922
Toll-free: 1-800-434-1922

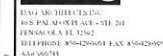

OWNERSHIP OF INSTRUMENTS OF SERVICE
ALL REPORTS, PLANS, SPECIFICATIONS, COMPUTER FILES, FIELD NOTES AND OTHER DOCUMENTS AND INSTRUMENTS PREPARED BY THE CONSULTANT AS INSTRUMENTS OF SERVICE SHALL REMAIN THE PROPERTY OF THE CONSULTANT. THE CONSULTANT SHALL RETAIN COMMON LAW, STATUTORY AND OTHER RESERVED RIGHTS INCLUDING THE RIGHT TO REPRODUCE THE INSTRUMENTS.

PHASE III

**Jay Elementary
Classroom Addition**
13833 S Alabama St,
Jay, FL 32565

D. PATRICK JEHL
P.E. 71528[illegible]

Drawn By:	ASM
Checked By:	DPJ

Date: August 1, 2011

Project No.:	170055
--------------	--------

Drawing Title:

SITE STORM

SITE STORM
WATER 8

WATER &

UTILITY DETAIL

UTILITY DETAIL

Drawing No. C009

C009

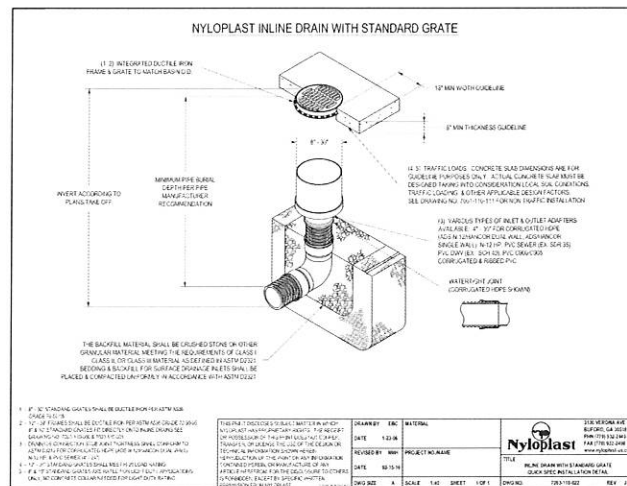
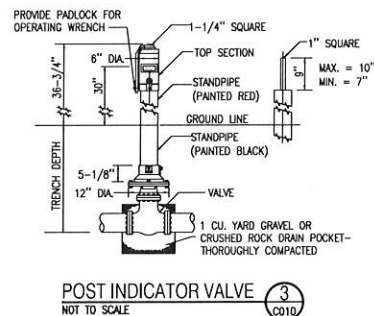

jhi **jehle-halstead, inc.**
Civil Engineering and Surveying
12140 W. Alameda Street • Aurora, CO 80015-1001
(303) 724-1911
www.jehle-halstead.com
Certificate of Incorporation No. 00330097
Surveying License Number 027883

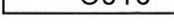



- NOTES:
1. SILTATION FENCE TO BE CONSTRUCTED TO LIMITS SHOWN PRIOR TO ANY OTHER SITE DEVELOPMENT.
 2. CONTRACTOR SHALL PERIODICALLY INSPECT FENCE LINE FOR SEDIMENT BUILD-UP. REMOVE SEDIMENT TO MAINTAIN MINIMUM 2' CLEAR FENCE FROM TOP (i.e. NO MORE THAN 2' SEDIMENT BUILD-UP).

SILTATION FENCE

NOT TO SCALE

1
C011



- NOTES:
1. FOR TEMPORARY USE DURING CONSTRUCTION, BARRICADE SHALL BE PLACED PRIOR TO ANY LAND DISTURBANCE
 2. FENCE MATERIAL SHALL BE PLACED AT THE DRIP LINE OF THE TREE OR GROUP OF TREES TO BE PROTECTED.
 3. NONE OF THE FOLLOWING ACTIVITIES SHALL OCCUR WITHIN THE TREE PROTECTION BARRICADE: DRIVING, PARKING, STORING MATERIALS, DUMPING WASTE, CONCRETE WASHOUT, ADDING FILL SOIL, TRENCHING, REMOVING SOIL OR GRUBBING.

TREE PROTECTION 2
 NOT TO SCALE C011



- NOTES:**
1. SEE WRITTEN SPECIFICATIONS FOR FULL DETAILS.
 2. PLACE SOD BEGINNING AT THE TOE OF THE SLOPE AND LONG EDGE PERPENDICULAR TO DIRECTION OF FLOW.
 3. SOD MUST BE PINNED ON ALL SLOPES 4:1 OR STEEPER, IN AREAS OF CONCENTRATED DRAINAGE FLOWS, AND ANYWHERE THAT THERE IS DANGER OF SOD SLIPPING.
 4. INSTALL SOD EDGES FLUSH WITH FINISHED GRADE OR ADJOINING SOD.

SODDING DETAIL 3
NOT TO SCALE C011



- NOTES:**
1. CONSTRUCTION ENTRANCES PROVIDE AN AREA WHERE MUD CAN BE REMOVED FROM VEHICLE TIRES BEFORE THEY LEAVE THE CONSTRUCTION SITE. THE MOTION OF THE VEHICLE AS IT MOVES OVER THE GRAVEL CONSTRUCTION MATERIAL DISLODGES CAKED MUD.
 2. IF THE ACTION OF THE VEHICLE ON THE GRAVEL PAD IS NOT SUFFICIENT TO DISLODGE MUD, THEN THE TIRES MUST BE WASHED BEFORE THE VEHICLE LEAVES THE SITE.
 3. UTILIZE GRAVEL, 2"-3" (MIN.) IN DIAMETER. GRAVEL LAYER SHOULD BE AT LEAST 6" THICK. THE PAD SHOULD BE AT LEAST 50' LONG. WIDTH SHOULD BE APPROPRIATE TO VEHICLE SIZE.

ROCK CONSTRUCTION ACCESS (5)
NOT TO SCALE C011



- GENERAL NOTES FOR EROSION AND SEDIMENT CONTROL

1. THE CONTRACTOR WILL BE RESPONSIBLE FOR THE INSTALLATION (PRIOR TO CONSTRUCTION) AND MAINTENANCE/REPAIRS OF (DURING CONSTRUCTION) EROSION AND SEDIMENT CONTROL MEASURES AS REQUIRED TO RETAIN ALL SEDIMENT AND EROSION ON THE SITE TO PREVENT, MINIMIZE AND CONTROL EROSION. MEASURES SHOWN HEREIN REPRESENT THE MINIMUM EROSION CONTROL MEASURES TO BE TAKEN.
2. ALL SOIL WASHED, DRIPPED, SPILLED, OR TRACKED OUTSIDE THE SITE OR ONTO PUBLIC RIGHTS-OF-WAY WILL BE REMOVED IMMEDIATELY.
3. ALL AREAS OF DISTURBANCE MUST BE TREATED AS APPROPRIATE TO PREVENT THE GENERATION OF DUST.
4. AT THE TIME OF SITE PREPARATION FOR PERMANENT VEGETATIVE STABILIZATION, ANY SOIL THAT WILL NOT PROVIDE A SUITABLE ENVIRONMENT TO SUPPORT PERMANENT VEGETATION MUST BE COVERED BY A SUITABLE MEANS TO PREVENT EROSION AND TO ADJUST THE SOIL CONDITIONS AND RENDER IT SUITABLE FOR PERMANENT COVER. IF THE REMOVAL OR TREATMENT OF THE SOIL WILL NOT PROVIDE SUITABLE CONDITIONS, NON-VEGETATIVE MEANS OF PERMANENT GROUND STABILIZATION MUST BE EMPLOYED.
5. THE CONTRACTOR MUST MAKE REGULAR INSPECTIONS OF ALL CONTROL MEASURES THROUGHOUT THE CONSTRUCTION PROCESS TO ENSURE THE OVERALL EFFECTIVENESS OF THE EROSION AND SEDIMENT CONTROL PLAN. AT A MINIMUM, INSPECTIONS MUST OCCUR AT LEAST ONCE A WEEK. INSPECTIONS OF THE EROSION AND SEDIMENT CONTROL OF A STORM EVENT THAT IS ONE-HALF (0.50) INCH OR GREATER, ALL INSPECTIONS MUST BE DOCUMENTED PER THE NPDES STORMWATER POLLUTION PREVENTION PLAN.
6. IN THE EVENT THAT AN ON-SITE INSPECTION BY ANY PARTY REVEALS A DEFICIENCY IN THE INSTALLATION AND/OR MAINTENANCE OF EROSION AND SEDIMENT CONTROL MEASURES, THE CONTRACTOR MUST BE RESPONSIBLE FOR THE IMMEDIATE REMEDIATION OF THE PROBLEM.
7. FAILURE TO COMPLY WITH THE REQUIRED EROSION AND SEDIMENT CONTROL GUIDELINES SPECIFIED IN THE PERMITS AND/OR ANY ADDENDUMS AND/OR ANY OTHER ORDERED DUE TO NON-COMPLIANCE, WILL BECOME THE RESPONSIBILITY OF THE CONTRACTOR.

SEQUENCE OF EROSION AND SEDIMENT CONTROL MEASURES IMPLEMENTATION

1. PRIOR TO ANY SOIL DISTURBANCE, SILT FENCE MUST BE INSTALLED ALONG ENTIRE DOWN-GRADE PERIMETER OF PROJECT AREA, AS SHOWN IN PLANS AND DETAILS, OR BY EQUIVALENT MEASURES. SILT FENCE MUST REMAIN IN PLACE UNTIL ALL UP-GRADE AREAS OF DISTURBANCE HAVE BEEN PERMANENTLY STABILIZED.
2. A PROPER CONSTRUCTION ENTRANCE MUST BE ESTABLISHED AT ALL POINTS OF INGRESS/EGRESS FROM CONSTRUCTION SITE, PER DETAIL PROVIDED IN THE PLANS, OR BY EQUIVALENT MEASURES. ALL CONSTRUCTION ENTRANCES MUST REMAIN IN PLACE UNTIL INGRESS/EGRESS FROM THE SITE AT THAT POINT HAS STOPPED.

CLEARING AND GRUBBING

1. ALL DISTURBED AREAS THAT WILL BE LEFT EXPOSED FOR MORE THAN FOURTEEN (14) DAYS, AND ARE NOT SUBJECT TO CONSTRUCTION TRAFFIC, MUST RECEIVE A TEMPORARY SEEDING IMMEDIATELY UPON DISTURBANCE. IF THE SEASON PREVENTS ESTABLISHMENT OF PERMANENT COVER, THE DISTURBED AREA WILL BE MULCHED WITH STRAW, OR EQUIVALENT MATERIAL TO A MINIMUM OF TWO (2) TONS PER ACRE.
2. ALL DISTURBED AREAS THAT ARE SUBJECT TO HIGH AMOUNTS OF EROSION (E.G. STEEP SLOPES, EMBANKMENTS GREATER THAN 3:1, OR OTHER AS DICTATED BY SITE CONDITIONS) MUST IMMEDIATELY RECEIVE A TEMPORARY SEEDING IN COMBINATION WITH MULCHING WITH STRAW, OR EQUIVALENT MATERIAL, AT A THICKNESS OF TWO (2) TO FOUR (4) INCHES MATED WITH THE TOP TWO (2) INCHES OF SOIL.
3. ALL DISTURBED AREAS MUST, AS A MINIMUM, BE WATERED BY WATER TO MINIMIZE THE GENERATION OF DUST.

SITE GRADING

1. THE SITE MUST, AT ALL TIMES, BE GRADED AND MAINTAINED SUCH THAT ALL STORM WATER RUNOFF IS CONTROLLED BY EROSION AND SEDIMENT CONTROL MEASURES.
2. ALL AREAS USED FOR MATERIAL STOCKPILE, BE IT FILL/EXCAVATED MATERIALS, STONE, OR OTHERWISE, ARE TO BE STABILIZED, AND MUST HAVE SILT FENCE INSTALLED PER THE DETAILS PROVIDED IN THE PLANS, OR BY EQUIVALENT MEASURES, AROUND THEIR ENTIRE DOWNGRADE PERIMETER.

INSTALLATION OF STORM SEWER AND UTILITIES

1. TEMPORARY OUTLET PROTECTION MUST BE INSTALLED AT ALL PROPOSED STORM WATER OUTFALLS PRIOR TO THE INSTALLATION OF THE DRAINAGE SYSTEM.
2. ALL SITE DRAINAGE, INCLUDING ROOF DRAINS, DOWN SPOUTS, GUTTERS, OR OTHERWISE MUST BE ROUTED TO CARRY ALL STORM WATER TO THE PROPOSED STORM WATER MANAGEMENT SYSTEM(S).
3. ANY SLOPES GREATER THAN 3:1 (H:V) RECEIVING PIPELINE OR UTILITY INSTALLATION MUST BE BACKFILLED AND STABILIZED DAILY AS THE INSTALLATION PROCEEDS.

FINAL SITEWORK

1. PERMANENT VEGETATION (I.E. SEED AND MULCH, SOD, ETC) TO BE INSTALLED ON ALL EXPOSED AREAS WITHIN TEN (10) DAYS AFTER FINAL GRADING.
2. UPON COMPLETION OF CONSTRUCTION, BUT PRIOR TO FINAL ACCEPTANCE, ALL CONSTRUCTION WASTE AND DEBRIS MUST BE REMOVED FROM THE SITE AND ALL PAVED ROADWAYS AND/OR PARKING AREAS MUST BE SWEEPED CLEAN OF ALL SEDIMENT.
3. TEMPORARY EROSION AND SEDIMENT CONTROL MEASURES MUST REMAIN IN PLACE AND BE MAINTAINED UNTIL SUCH TIME WHEN ALL UP-GRADE AREAS HAVE BEEN PERMANENTLY STABILIZED.

SITE EROSION CONTROL DETAILS



DAW AND THIEFFS LTD
405 P.M. OXLEY CT. STE 201
DENVER CO 80202
TELEPHONE: 800-429-9041 FAX: 303-429-9999
303-550-7115

OWNERSHIP OF INSTRUMENTS OF SERVICE
ALL REPORTS, PLANS, SPECIFICATIONS, COMPUTATIONS, FIELD DATA, NOTES AND OTHER DOCUMENTS AND INSTRUMENTS PREPARED BY THE CONSULTANT AS INSTRUMENTS OF SERVICE SHALL REMAIN THE PROPERTY OF THE CONSULTANT. THE CONSULTANT SHALL RETAIN ALL COMMON LAW, STATUTORY AND OTHER RESERVED RIGHTS INCLUDING THE COPYRIGHT IN THE REPORTS.

PHASE III

**Jay Elementary
Classroom Addition**
13833 S Alabama St,
Jay, FL 32565

D. PATRICK JEHL, JR.
P.E. 71528

[illegible]

Drawn By:	ASM
Checked By:	DPJj

Date: August 1, 2011

Project No.: 170055

Drawing Title:

SITE EROSION CONTROL DETAILS

Drawing No.: C011

jhi jehle-halstead, inc.
Civil Engineering and Surveying
1246 W. Parker Street • P.O. Box 2200 • Cedar Rapids, IA 52402
(319) 794-9600
www.jehle-halstead.com
Certificate of Accreditation No. 00069997
Surveying License No. 14, 15 and 18 (M&S)

 **FOUNDATION PLAN**
SCALE 1/8" = 1'-0"

