

ENERGY UPGRADES
AT
KING MIDDLE SCHOOL

5928 STEWART ST.
MILTON, FL 32570

FOR THE
SCHOOL BOARD OF
SANTA ROSA COUNTY

PHASE I
SCHEMATIC DESIGN

PROJECT INDEX:

GENERAL:

A000 Set Cover Sheet - Project Stats, Sheet Index, Design Team.

ARCHITECTURAL SHEETS:

A100 Overall Plan

B4

Project Sheet Index

SCALE: NTS

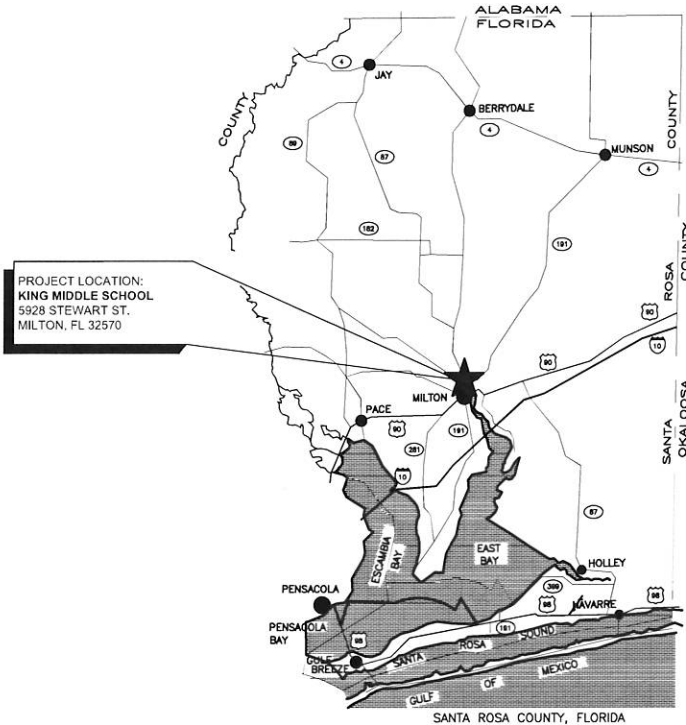

A4

Vicinity Map

SCALE: NTS

OWNER CONTACTS:

Santa Rosa County School Board
Santa Rosa County, FL
Phone: 850-983-5123
Fax: 850-983-5115

Joseph B. Harrell
Administrative Superintendent for
Administrative Services
Email:
Harrelj@mail.santarosa.k12.fl.us

ARCHITECT:

DAG Architects, Inc.
40 South Palafox Place, Suite 201
Pensacola, Florida 32502
Phone: 850-429-9004
Fax: 850-429-9005

PIC: Dave Luttrell, AIA
PM: Owen Gipson, AIA
Email: ogipson@dagarchitects.com

ELECTRICAL:

Schmidt Consulting Group, Inc.
40 S. Palafox Place, Suite 300
Pensacola, FL 32502
Phone: 850-438-0050
Fax: 850-432-8631

Todd Nicholson, PE
Email: toddn@schmidtconsulting
group.com

TELECOMMUNICATIONS:

Schmidt Consulting Group, Inc.
40 S. Palafox Place, Suite 300
Pensacola, FL 32502
Phone: 850-438-0050
Fax: 850-432-8631

Todd Nicholson, PE
Email: toddn@schmidtconsulting
group.com

CIVIL & SURVEYING:

Jehle-Halstead, Inc.
5414 Highway 90
Milton, FL 32571
Phone: 850-994-9503
Fax: 850-994-9504

Patrick Jehle, Jr. E.I.
Email: pjehle@jehle-halstead.com

A1

Project Teams and Discipline
Allocation

SCALE: NTS



DAG ARCHITECTS INC.
40 S. PALAFOX PLACE - STE 201
PENSACOLA, FL 32502
TELEPHONE: 850-429-9004 FAX: 850-429-9005
AA-C000745

OWNERSHIP OF INSTRUMENTS OF SERVICE
ALL REPORTS, PLANS, SPECIFICATIONS, COMPUTER FILES, FIELD DATA,
NOTES AND OTHER DOCUMENTS AND INSTRUMENTS PREPARED BY
THE CONSULTANT AS INSTRUMENTS OF SERVICE SHALL REMAIN THE
PROPERTY OF THE CONSULTANT. THE CONSULTANT SHALL RETAIN ALL
COMMON LAW, STATUTORY AND OTHER RESERVED RIGHTS,
INCLUDING THE COPYRIGHT THEREON.

SCHEMATIC
DESIGN
(PHASE I)

King Middle School
Energy Upgrades
5928 Stewart St.
Milton, FL 32570

Revision

Date:	No.	Description:

Drawn By: SJT
Checked By: OEG

Date: 9-14-17

Project No.: 17043

Drawing Title:

Set Cover Sheet -
Project Stats, Code Review,
Sheet Index & Design Team

Drawing No.:

A-000

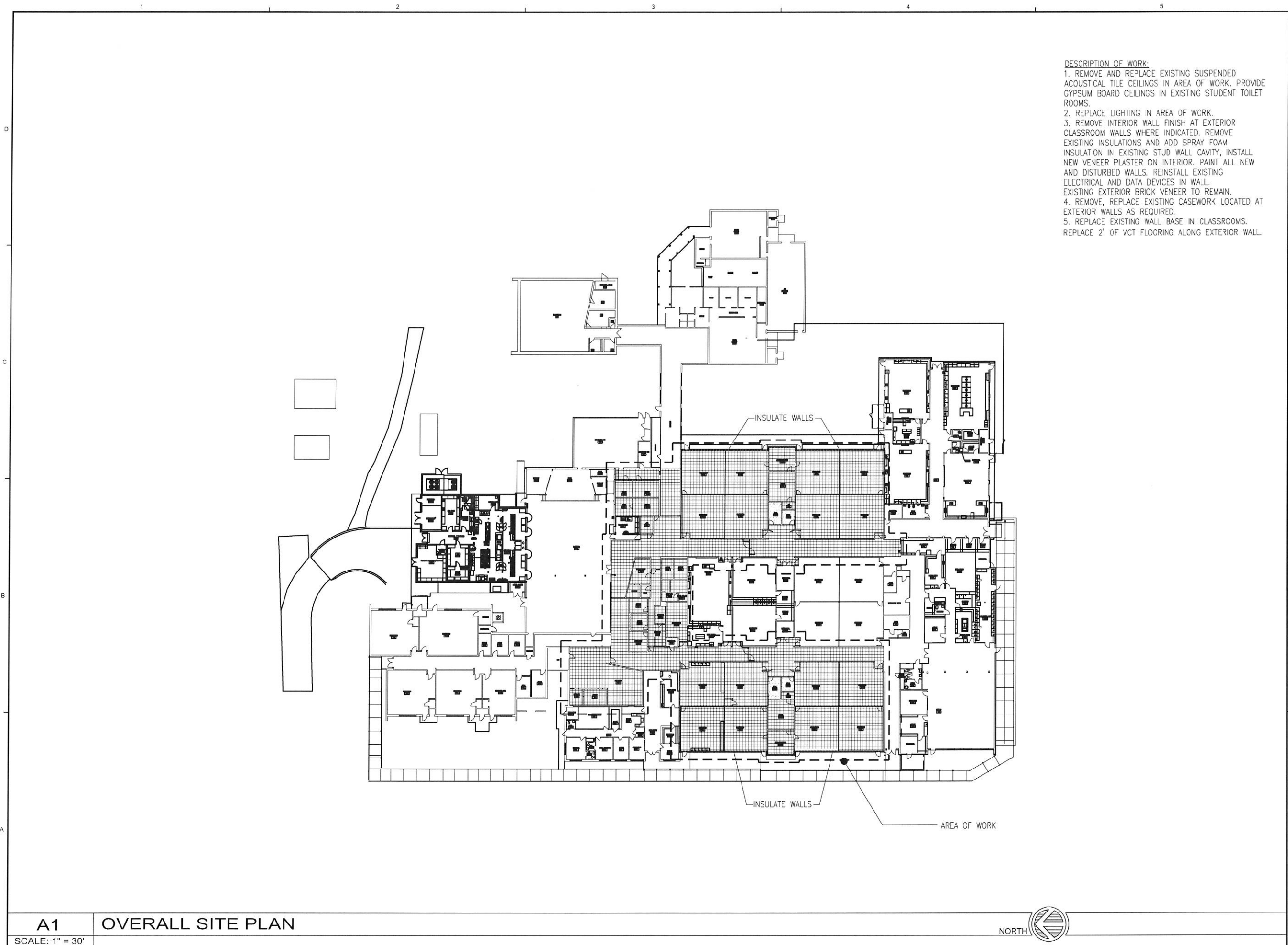

- DESCRIPTION OF WORK:
1. REMOVE AND REPLACE EXISTING SUSPENDED ACOUSTICAL TILE CEILINGS IN AREA OF WORK. PROVIDE GYPSUM BOARD CEILINGS IN EXISTING STUDENT TOILET ROOMS.
 2. REPLACE LIGHTING IN AREA OF WORK.
 3. REMOVE INTERIOR WALL FINISH AT EXTERIOR CLASSROOM WALLS WHERE INDICATED. REMOVE EXISTING INSULATIONS AND ADD SPRAY FOAM INSULATION IN EXISTING STUD WALL CAVITY, INSTALL NEW VENEER PLASTER ON INTERIOR. PAINT ALL NEW AND DISTURBED WALLS. REINSTALL EXISTING ELECTRICAL AND DATA DEVICES IN WALL. EXISTING EXTERIOR BRICK VENEER TO REMAIN.
 4. REMOVE, REPLACE EXISTING CASEWORK LOCATED AT EXTERIOR WALLS AS REQUIRED.
 5. REPLACE EXISTING WALL BASE IN CLASSROOMS. REPLACE 2' OF VCT FLOORING ALONG EXTERIOR WALL.



DAG ARCHITECTS INC.
40 S. PALAFOX PLACE - STE 201
PENSACOLA, FL 32502
TELEPHONE: 850-429-9004 FAX: 850-429-9005
AA-C000745

OWNERSHIP OF INSTRUMENTS OF SERVICE

ALL REPORTS, PLANS, SPECIFICATIONS, COMPUTER FILES, FIELD DATA, NOTES AND OTHER DOCUMENTS AND INSTRUMENTS PREPARED BY THE CONSULTANT AS INSTRUMENTS OF SERVICE SHALL REMAIN THE PROPERTY OF THE CONSULTANT. THE CONSULTANT SHALL RETAIN ALL COMMON LAW, STATUTORY AND OTHER RESERVED RIGHTS, INCLUDING THE COPYRIGHT THEREIN.

**SCHEMATIC
DESIGN
(PHASE I)**

**King Middle School
Energy Upgrades**

5928 Stewart St.
Milton, FL 32570

Revision		
Date:	No.	Description:
-	-	-
-	-	-
-	-	-
-	-	-
-	-	-
-	-	-
-	-	-
-	-	-
-	-	-

Drawn By: SJT
Checked By: OEG

Date: 9-14-17

Project No.: 17043

Drawing Title:
CONSTRUCTION ACCESS
SITE PLAN

Drawing No.: **A100**