

SHEET FORMAT IS 22" X 34". IF PRINTED SHEET IS NOT 22" X 34", THEN IT IS NOT TO SCALE

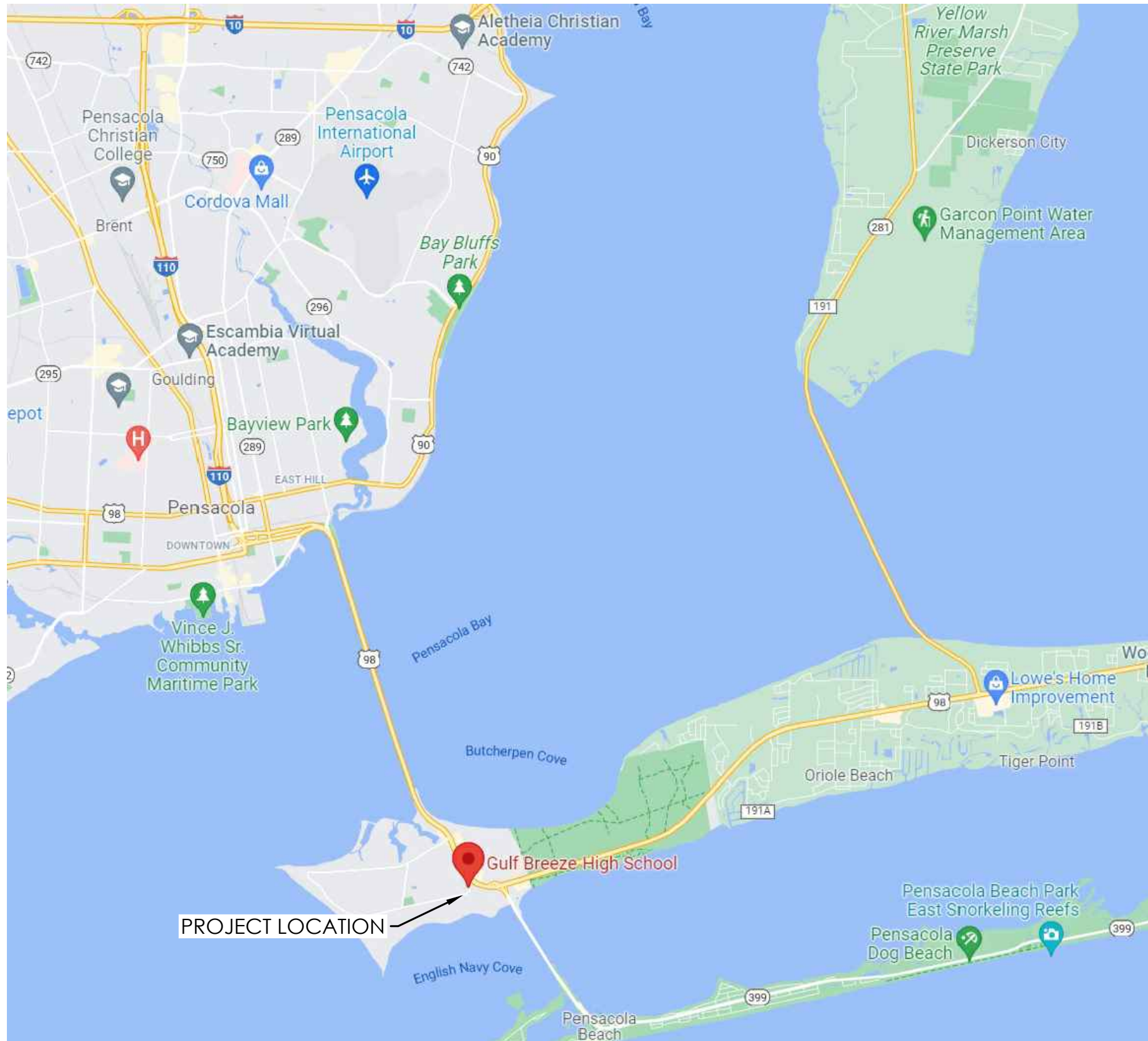

# GREASE TRAP REPLACEMENT PLUMBING RENOVATION

GULF BREEZE HIGH SCHOOL  
675 GULF BREEZE PARKWAY  
GULF BREEZE, FL 32561



**1** LOCATION MAP  
NOT TO SCALE

DRAWING INDEX				
SHEET	OF	SHEET	SHEET#	SHEET NAME
GENERAL				
1	OF	5	G001	COVER SHEET AND DRAWING INDEX
MECHANICAL				
2	OF	5	P001	PLUMBING LEGEND AND ABBREVIATIONS
3	OF	5	P002	PLUMBING NOTES
4	OF	5	P101	PLUMBING DEMOLITION PLAN
5	OF	5	P201	PLUMBING PLAN

## PHASE 1+2 DESIGN SUBMITTAL DESIGN REVIEW SET

### OWNER REPRESENTATIVES:

JOSEPH B. "JOEY" HARRELL  
ASSISTANT SUPERINTENDENT FOR  
ADMINISTRATIVE SERVICES

RICHARD LAING  
SUPERVISOR OF BUILDING MAINTENANCE

RICK GRIMES  
MAINTENANCE FOREMAN II

JOE GILLMAN  
BUILDING AND ENERGY MANAGEMENT

SANTA ROSA COUNTY SCHOOL DISTRICT  
ADMINISTRATIVE SUPPORT COMPLEX  
6544 FIREHOUSE ROAD  
MILTON, FL 32570

### DESIGN TEAM:

MECHANICAL ENGINEER:  
ANTON LEE, PE  
ANTON LEE ENGINEERING, LLC  
1765 E. NINE MILE RD., STE. 1 #220  
PENSACOLA, FL 32514



ANTON LEE ENGINEERING, LLC  
PENSACOLA, FL 32514

CERT. OF AUTHORIZATION:  
FLORIDA 32794  
ALABAMA 5685-E

GREASE TRAP REPLACEMENT  
PLUMBING RENOVATION  
SANTA ROSA COUNTY SCHOOL DISTRICT  
GULF BREEZE HIGH SCHOOL  
675 GULF BREEZE PARKWAY, GULF BREEZE, FL 32561

PRELIMINARY  
2022-01-06  
NOT FOR CONSTRUCTION

Revision		
No.	Date:	Description:

Drawn By: AL  
Checked By: AL

Date: 01-06-2022

AL Project No: 21-144

Drawing Title:  
COVER SHEET AND  
DRAWING INDEX

Drawing No.:  
**G001**

SHEET FORMAT IS 22" X 34". IF PRINTED SHEET IS NOT 22" X 34", THEN IT IS NOT TO SCALE

ABBREVIATIONS			
AAV	AIR ADMITTANCE VALVE	GPM	GALLONS PER MINUTE
ABA	ARCHITECTURAL BARRIERS ACT	GPH	GALLONS PER HOUR
ABS	ACRYLONITRILE BUTADIENE STYRENE PLASTIC	GWH	GAS WATER HEATER
A/C	ABOVE CEILING	HB	HOSE BIBB
A/D	ACCESS DOOR	HR	HOSE REEL
ADA	AMERICANS WITH DISABILITY ACT	INV	INVERT
AFF	ABOVE FINISH FLOOR	IWH	INSTANTANEOUS WATER HEATER
AGA	AMERICAN GAS ASSOCIATION	LAV	LAVATORY
ANSI	AMERICAN NATIONAL STANDARDS INSTITUTE	LAV	LAVATORY
ASHRAE	AMERICAN SOCIETY OF HEATING, REFRIGERATING, AND AIR-CONDITIONING ENGINEERS	MECH	MECHANICAL
		NSF	NATIONAL SCIENCE FOUNDATION
ASSE	AMERICAN SOCIETY OF SANITARY ENGINEERING	PSI	POUNDS PER SQUARE INCH
		PRD	PRIMARY ROOF DRAIN
		PRL	PRIMARY RAIN LEADER
BFP	BACKFLOW PREVENTER	SAN	SANITARY
CA	COMPRESSED AIR	SK	SINK
CFH	CUBIC FEET PER HOUR	SS	STAINLESS STEEL
CFM	CUBIC FEET PER MINUTE	SRD	SECONDARY ROOF DRAIN
CO	CLEANOUT	SRL	SECONDARY RAIN LEADER
DCW	DOMESTIC COLD WATER	TYP	TYPICAL
DHW	DOMESTIC HOT WATER	T/P	TEMPERATURE AND PRESSURE
DHWR	DOMESTIC HOT WATER RETURN	TP	TRAP PRIMER
DEG	DEGREES	UP	UP
DF	DRINKING FOUNTAIN	U/G	UNDERGROUND
DFU	DRAINAGE FIXTURE UNIT		
DIA	DIAMETER	V	VENT
DN	DOWN	VTR	VENT THROUGH ROOF
DW	DISHWASHER		
ELEV	ELEVATION	W/	WITH
EW	ELECTRIC WATER COOLER	W	WASTE
EW	ELECTRIC WATER HEATER	WC	WATER CLOSET (TOILET)
EPA	ENVIRONMENTAL PROTECTION AGENCY	WCO	WALL CLEANOUT
		WH	WALL HYDRANT
		WHA	WATER HAMMER ARRESTOR
		WSFU	WATER SUPPLY FIXTURE UNIT
FCO	FLOOR CLEANOUT		
FD	FLOOR DRAIN	(E)	EXISTING
FT	FOOT OR FEET	(N)	NEW
FV	FLUSH VALVE		
G	NATURAL GAS		
GALV	GALVANIZED		
GCO	GRADE CLEANOUT		
GPF	GALLONS PER FLUSH		
			NOTE: NOT ALL ABBREVIATIONS ARE USED ON THESE DRAWINGS.

PROJECT BUILDING CODE REQUIREMENTS

- WORK SHALL COMPLY WITH THE FOLLOWING AGENCIES:
- 2020 FLORIDA BUILDING CODE (FBC)
  - 2020 FLORIDA MECHANICAL CODE (FMC)
  - 2020 FLORIDA ENERGY CONSERVATION CODE (FECC)
  - 2020 FLORIDA PLUMBING CODE (FPC)
  - 2020 FLORIDA FIRE PREVENTION CODE (FFPC)
  - AMERICAN SOCIETY OF HEATING AND REFRIGATION ENGINEERS (ASHRAE)
  - AMERICAN SOCIETY OF PLUMBING ENGINEERS (ASPE)
  - NATIONAL FIRE PROTECTION ASSOCIATION (NFPA)
  - NFPA 70 NATIONAL ELECTRICAL CODE
  - NFPA 101 LIFE SAFETY CODE

GENERAL ANNOTATION LEGEND

1

TITLE

—

DESCRIPTION

1

SCALE

—

DWG SCALE, SCHEMATIC, OR NOT TO SCALE (NTS)

1

P301

BUILDING SECTION

1

P301

BUILDING ELEVATION

1

SHEET NOTE

1

DETAIL NOTE

1

REVISION # AND CLOUD

- GENERAL PLUMBING NOTES
- PRIOR TO BEGINNING CONSTRUCTION, FIELD VERIFY THE EXACT LOCATION, SIZE, DEPTH, DIRECTION OF FLOW, CAPACITY, PIPE MATERIAL, AND CONDITION OF EXISTING PIPING TO ENSURE THAT PROPER CONNECTIONS TO AND EXTENSION OF SUCH UTILITIES CAN BE MADE.
  - PRIOR TO CONSTRUCTION, FIELD VERIFY EXISTING CONDITIONS AND MAKE ADJUSTMENTS AS REQUIRED TO ENSURE PROPER CONNECTIONS TO UTILITIES.
  - SITE INSPECTION: CONTRACTOR SHALL VISIT THE SITE OF WORK PRIOR TO SUBMISSION OF HIS BID AND THOROUGHLY FAMILIARIZE HIMSELF WITH THE WORKING CONDITIONS AND EXACT NATURE OF THE WORK. SUBMISSION OF A BID ACKNOWLEDGES FULL RESPONSIBILITY FOR PROVIDING ALL NECESSARY LABOR AND MATERIALS TO ENSURE COMPLETE, FUNCTIONAL, AND COMPLIANT SYSTEMS. FAILURE TO MEET THIS REQUIREMENT SHALL NOT BE CONSIDERED JUSTIFICATION FOR OMISSIONS, FAULTY WORK, OR THE PAYMENT OF ADDITIONAL COMPENSATION.
  - CONTRACTOR SHALL COORDINATE ALL WORK WITH THE WORK OF OTHER TRADES TO AVOID CONFLICTS AND TO MINIMIZE INTERRUPTION OF SERVICES.
  - ALL WORK, METHODS, AND INSTALLATIONS SHALL BE IN ACCORDANCE WITH THE PREVAILING BUILDING CODE, INSPECTION REGULATIONS AND ALL OFFICIALS HAVING JURISDICTION.
  - DUE TO THE SCALE OF DRAWINGS, NOT ALL PIPING AND APPURTENANCES TO BE PROVIDED ARE SHOWN. CONTRACTOR SHALL PROVIDE SERVICES INCLUDING, BUT NOT LIMITED TO, THE FOLLOWING: PIPING INSIDE WALLS AND CHASES TO SERVE ADJACENT PLUMBING FIXTURES AND EQUIPMENT, INDIVIDUAL FIXTURE SUPPLIES AND DRAINS, PIPING OFFSETS, VALVES, TRAPS, GAUGES, STRAINERS, AND UNIONS TO ENSURE THE COMPLETE AND FUNCTIONING INSTALLATION OF FIXTURES AND EQUIPMENT.
  - COORDINATE ROUTING OF PIPING BELOW SLAB WITH COLUMN FOUNDATIONS, PILINGS, GRADE BEAMS, UNDERGROUND PLUMBING, ELECTRICAL UTILITIES, AND OTHER SUB-SURFACE BUILDING ELEMENTS.
  - NO PIPING IS TO BE INSTALLED OPEN TO PUBLIC VIEW UNLESS NOTED OTHERWISE.
  - DO NOT INSTALL PIPING AT LOCATIONS THAT INTERFERE WITH SERVICE ACCESSIBILITY TO EQUIPMENT.
  - ALL PENETRATIONS THROUGH FLOOR SLABS AND EXTERIOR WALLS SHALL BE SEALED WATERTIGHT.
  - ALL EXISTING WALLS, FLOORS, DRIVEWAYS, SIDEWALKS, PARKING AREAS, FENCING, ETC. DISTURBED DUE TO WORK DONE AND THAT ARE TO REMAIN SHALL BE REPAIRED TO CONDITION THAT IS ACCEPTABLE TO THE ARCHITECT/ENGINEER AND OWNER.
  - PROVIDE CLEANOUTS IN ADDITION TO THOSE SHOWN AS REQUIRED BY CODE.
  - UPON COMPLETION OF WORK, THOROUGHLY ROD AND FLUSH OUT ALL GRAVITY DRAINAGE PIPING TO ENSURE IT IS FREE FROM BLOCKAGES AND FLOWING FREELY.
  - UNDER SLAB SOIL, WASTE AND VENT PIPING PASSING TO UNDERSIDE OR THROUGH FOUNDATION FOOTING, WALL OR GRADE BEAM SHALL BE PROVIDED WITH A RELIEVING ARCH OR PIPE SLEEVE - TWO PIPE SIZES GREATER THAN PIPE SIZE INDICATED ON PLANS. COORDINATE FINAL PIPE ROUTING AND LAYOUT WITH STRUCTURAL DRAWINGS.
  - PRIOR TO SUBSTANTIAL COMPLETION OF NEW WORK AREAS, CONTRACTOR SHALL HAVE SANITARY PLUMBING SYSTEM CLEARED OF DEBRIS OR ANY MATTER THAT WOULD INTERFERE OR PREVENT ADEQUATE CONVEYANCE OF MATERIALS FROM MOVING THROUGH AND TERMINATING INTO BUILDING OR PUBLIC DISPOSAL FACILITIES.

PLUMBING LEGEND

	SANITARY PIPING (SAN)		ELBOW TURN UP
	VENT PIPING (V)		ELBOW TURN DOWN
	COLD WATER SUPPLY PIPING (DCW)		BOTTOM CONNECTION
	HOT WATER SUPPLY PIPING (DHW)		TOP CONNECTION
	HOT WATER RETURN PIPING (DHWR)		GATE VALVE
	INTERIOR HOSE BIBB (HB) OR EXTERIOR WALL HYDRANT (WH)		BALL VALVE
	WALL CLEANOUT (WCO)		BUTTERFLY VALVE
	FLOOR CLEANOUT (CO)		BALANCING VALVE
	FLOOR DRAIN (FD)		SPRING CHECK VALVE
	GRADE CLEANOUT (GCO)		PRESSURE REDUCING VALVE
	VENT THRU ROOF (VTR)		TEMP/PRESSURE (T/P) RELIEF VALVE. PIPE FULL SIZE DISCHARGE TO FLOOR DRAIN.
	WATER HAMMER ARRESTOR (WHA)		UNION
	MIXING VALVE (MV)		GLOBE VALVE
	EQUIPMENT WITH CLEARANCE SHOWN IN DASHED LINE		GAS COCK
	NEW EQUIPMENT TAG		STRAINER WITH BLOW DOWN GATE VALVE FULL SIZE OF STRAINER AND 3/4" HOSE END CONNECTION WITH CAP
	EXISTING EQUIPMENT TAG		PRESSURE GAUGE
	CONNECT TO EXISTING		TEMPERATURE GAUGE
	EQUIPMENT TO BE DEMOLISHED		
	PIPING TO BE DEMOLISHED		



ANTON LEE ENGINEERING, LLC  
PENSACOLA, FL 32514

CERT. OF AUTHORIZATION:  
FLORIDA 32794  
ALABAMA 5685-E

GREASE TRAP REPLACEMENT  
PLUMBING RENOVATION  
SANTA ROSA COUNTY SCHOOL DISTRICT  
GULF BREEZE HIGH SCHOOL  
675 GULF BREEZE PARKWAY, GULF BREEZE, FL 32561

PRELIMINARY

2022-01-06

NOT FOR CONSTRUCTION

Revision		
No.	Date:	Description:

Drawn By: AL  
Checked By: AL

Date: 01-06-2022

AL Project No: 21-144

Drawing Title:  
PLUMBING LEGEND  
AND ABBREVIATIONS

Drawing No.:  
P001

SHEET FORMAT IS 22" X 34". IF PRINTED SHEET IS NOT 22" X 34", THEN IT IS NOT TO SCALE

GENERAL DEMOLITION NOTES		
		<div>1. THE CONTRACTOR SHALL BE RESPONSIBLE FOR TEMPORARILY AND PERMANENT WEATHERPROOFING OF THE INSTALLATION. THE CONTRACTOR SHALL BE FULLY LIABLE FOR ANY WATER DAMAGE OR OTHER DAMAGE FROM THE ELEMENTS CAUSED TO THE OWNER'S PROPERTY AS A RESULT OF THE CONTRACTOR'S FAILURE TO PROVIDE THE NECESSARY WEATHERPROOFING DURING THE COURSE OF WORK UNDER THIS CONTRACT.</div> <div>2. DRAWINGS SHOWING EXISTING EQUIPMENT, DUCTWORK, ELECTRICAL, AND PIPING CONNECTIONS ARE DIAGRAMMATIC AND ARE INTENDED ONLY TO DEPICT THE GENERAL ARRANGEMENT, APPROXIMATE SIZE, AND OVERALL PROXIMITY OF THE EXISTING SYSTEM ELEMENTS. EACH CONTRACTOR AND SUBCONTRACTOR SHALL BE RESPONSIBLE FOR VISITING THE SITE OF WORK TO VERIFY EXISTING CONDITIONS PRIOR TO COMMENCING THE CONSTRUCTION.</div> <div>3. THE CONTRACTOR SHALL ADDITIONALLY BE RESPONSIBLE FOR MAKING ACCURATE FIELD MEASUREMENTS OF ALL EXISTING CONDITIONS RELATING TO THE DESIGN AND INSTALLATION OF NEW MECHANICAL EQUIPMENT, PIPING, DUCTWORK, ETC PRIOR TO COMMENCING WORK. PROPER SIZING OF THE PHYSICAL ASPECTS OF NEW EQUIPMENT AND PLUMBING FIXTURES TO MATCH EXISTING CONDITIONS SHALL BE THE SOLE RESPONSIBILITY OF THE CONTRACTOR.</div> <div>4. UNLESS NOTED OTHERWISE, ANY AND ALL DAMAGE TO THE EXISTING BUILDING SITE, EXTERIOR BUILDING FINISHES, BUILDING STRUCTURE, BUILDING SYSTEMS (MECHANICAL, ELECTRICAL, ETC.), INTERIOR BUILDING FINISHES, OR BUILDING FURNISHINGS CAUSED BY THE CONTRACTOR DURING THE COURSE OF WORK UNDER THIS CONTRACT SHALL BE REPLACED AND/OR REPAIRED BY THE CONTRACTOR AT NO ADDITIONAL COST TO THE OWNER. REPLACEMENT AND/OR REPAIR OF DAMAGED ITEMS SHALL BE MADE TO THE COMPLETE SATISFACTION OF THE OWNER, AND AS A MINIMUM SHALL RETURN THE DAMAGED ITEMS TO THE CONDITION IN WHICH THEY WERE FOUND PRIOR TO THE COMMENCEMENT OF THIS WORK.</div> <div>5. PLACEMENT OF EQUIPMENT AND MATERIALS REQUIRED FOR THIS WORK SHALL BE THE SOLE RESPONSIBILITY OF THE CONTRACTOR. ACCORDINGLY, THE CONTRACTOR SHALL INCLUDE IN HIS BID THE COST OF PROPER PLACEMENT MACHINERY AND EQUIPMENT. THE CONTRACTOR SHALL BE FULLY LIABLE FOR ANY DAMAGE CAUSED TO THE BUILDING OR BUILDING SITE DURING EQUIPMENT PLACEMENT OPERATIONS. THIS INCLUDES BUT IS NOT LIMITED TO DAMAGE TO SITE ITEMS SUCH AS LANDSCAPING, GRASSING, SIDEWALKS, AND EXTERIOR LIGHTING.</div> <div>6. SEE NEW WORK FOR EXTENT OF NEW EQUIPMENT AND PLUMBING FIXTURES. CARE SHALL BE TAKEN NOT TO DAMAGE ANY EXISTING EQUIPMENT IN THE SPACE.</div> <div>7. INFORMATION INDICATING LOCATION OF EXISTING PLUMBING FIXTURES, EQUIPMENT, DUCTWORK AND PIPING WAS OBTAINED FROM EXISTING AS BUILT DRAWINGS AND SITE VISITS AND ARE REPRESENTATIVE OF THE BEST AVAILABLE SOURCE TO DATE.</div> <div>8. PRIOR TO SUBSTANTIAL, CONTRACTOR SHALL PATCH OR REPLACE ALL DAMAGED WALL, CEILING, AND FLOOR DURING CONSTRUCTION TO MATCH EXISTING. PAINT TO MATCH EXISTING.</div> <div>9. ALL REMOVED MECHANICAL/PLUMBING ASSOCIATED ITEMS REMOVED SHALL BECOME THE PROPERTY OF THE CONTRACTOR AND SHALL BE TRANSFERRED FROM JOB SITE, EXCEPT ITEMS SELECTED BY OWNER AND THESE ITEMS SHALL BE RELOCATED TO STORAGE AREA DESIGNATED BY THE OWNER. ALL DEMOLISHED ITEMS THAT INCLUDES BUT NOT LIMITED TO DIRT, DEBRIS, EQUIPMENT, ETC SHALL BE HAULED BY THE CONTRACTOR AWAY FROM THE JOBSITE.</div>



ANTON LEE ENGINEERING, LLC  
PENSACOLA, FL 32514

CERT. OF AUTHORIZATION:  
FLORIDA 32794  
ALABAMA 5685-E

GREASE TRAP REPLACEMENT  
PLUMBING RENOVATION  
SANTA ROSA COUNTY SCHOOL DISTRICT  
GULF BREEZE HIGH SCHOOL  
675 GULF BREEZE PARKWAY, GULF BREEZE, FL 32561

PRELIMINARY

2022-01-06

NOT FOR CONSTRUCTION

Revision		
No.	Date:	Description:

Drawn By:

Checked By:

AL

AL

Date:

01-06-2022

AL Project No:

21-144

Drawing Title:

PLUMBING NOTES

Drawing No.:

P002

SHEET FORMAT IS 22" X 34". IF PRINTED SHEET IS NOT 22" X 34", THEN IT IS NOT TO SCALE

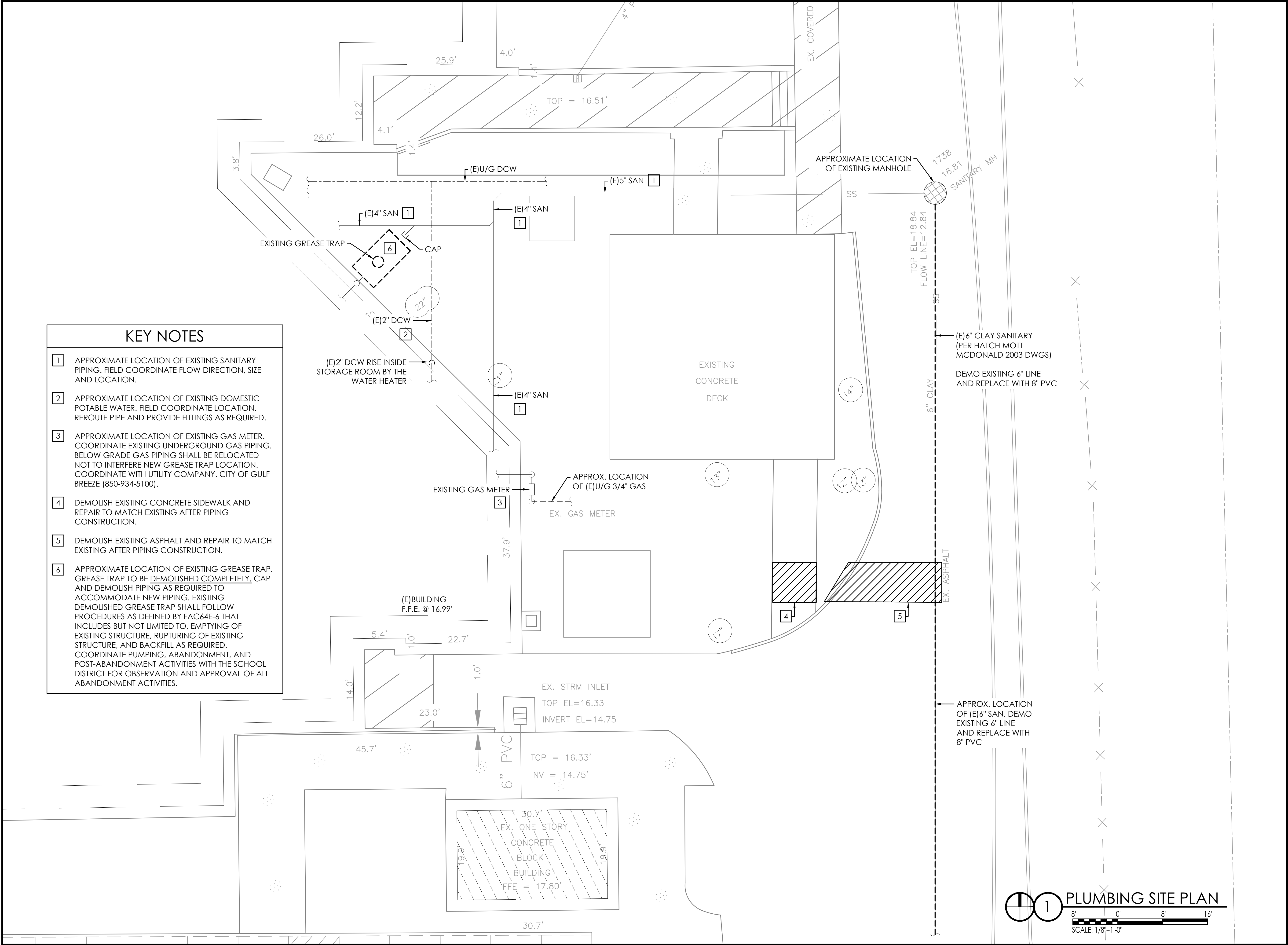

ANTON LEE  
ENGINEERING

ANTON LEE ENGINEERING, LLC  
PENSACOLA, FL 32514

CERT. OF AUTHORIZATION:  
FLORIDA 32794  
ALABAMA 5685-E

# GREASE TRAP REPLACEMENT PLUMBING RENOVATION SANTA ROSA COUNTY SCHOOL DISTRICT GULF BREEZE HIGH SCHOOL 675 GULF BREEZE PARKWAY, GULF BREEZE, FL 32561

PRELIMINARY  
2022-01-06  
NOT FOR CONSTRUCTION

Revision		
No.	Date	Description

Drawn By: AL  
Checked By: AL

Date: 01-06-2022

AL Project No: 21-144

Drawing Title:  
PLUMBING DEMO PLAN

Drawing No.:  
P101

**KEY NOTES**

1. CONNECT TO EXISTING SANITARY PIPE. FIELD COORDINATE INVERT LOCATION PRIOR TO CONNECTION.
2. (3) 1,250 GALLON GREASE INTERCEPTOR. PRECAST CONCRETE. PROVIDE LID EXTENSION.
3. VENT TO GOOSENECK. SECURE VERTICAL PIPING TO EXISTING WALL. PAINT SCH. 40 PIPE TO MATCH WALL. GOOSENECK AT 18" AFF. PROVIDE WITH INSECT SCREEN.
4. PROVIDE CONCRETE PAD. TOP ELEVATION TO FLUSH WITH EXISTING SIDEWALK. FIELD COORDINATE. SLOPE AWAY FROM EXISTING FREEZER/COOLER STRUCTURE AND EXISTING CONCRETE PATIO. LIGHT BROOM FINISH.

**EXISTING CONCRETE DECK**

**EXISTING TREES. COORDINATE WITH SCHOOL DISTRICT.**

**RELOCATE U/G GAS PIPING. COORDINATE WITH UTILITY COMPANY.**

**APPROXIMATE LOCATION OF EXISTING MANHOLE (E) 6" SAN INVERT ELEVATION @ 12.84**

**APPROX. INVERT ELEVATION AT 12.13'. FIELD VERIFY.**

**APPROXIMATE LOCATION OF EXISTING MANHOLE**

**SCALE: 1/8"=1'-0"**

**PARTIAL PLUMBING PLAN**



ERT. OF AUTHORIZATION:  
LORIDA 32794  
LABAMA 5685-E

# GREASE TRAP REPLACEMENT PLUMBING RENOVATION

SANTA ROSA COUNTY SCHOOL DISTRICT  
GULF BREEZE HIGH SCHOOL  
675 GULF BREEZE PARKWAY, GULF BREEZE, FL 32561

2022-01-06

NOT FOR CONSTRUCTION

Revision		
No.	Date:	Description:

AL

01-06-2022

21-144

Drawing No.:

# P102