

# Holley-Navarre Middle School

## CAFETERIA/KITCHEN EXPANSION

FOR THE  
SANTA ROSA COUNTY SCHOOL BOARD



PINDER-MARTIN ASSOCIATES, INC.  
1001 N. 12th AVENUE  
PENSACOLA, FL. 32501  
850-438-9110  
AA28000896

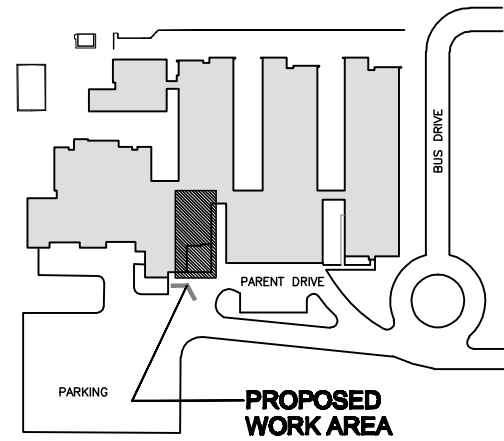

KEY PLAN

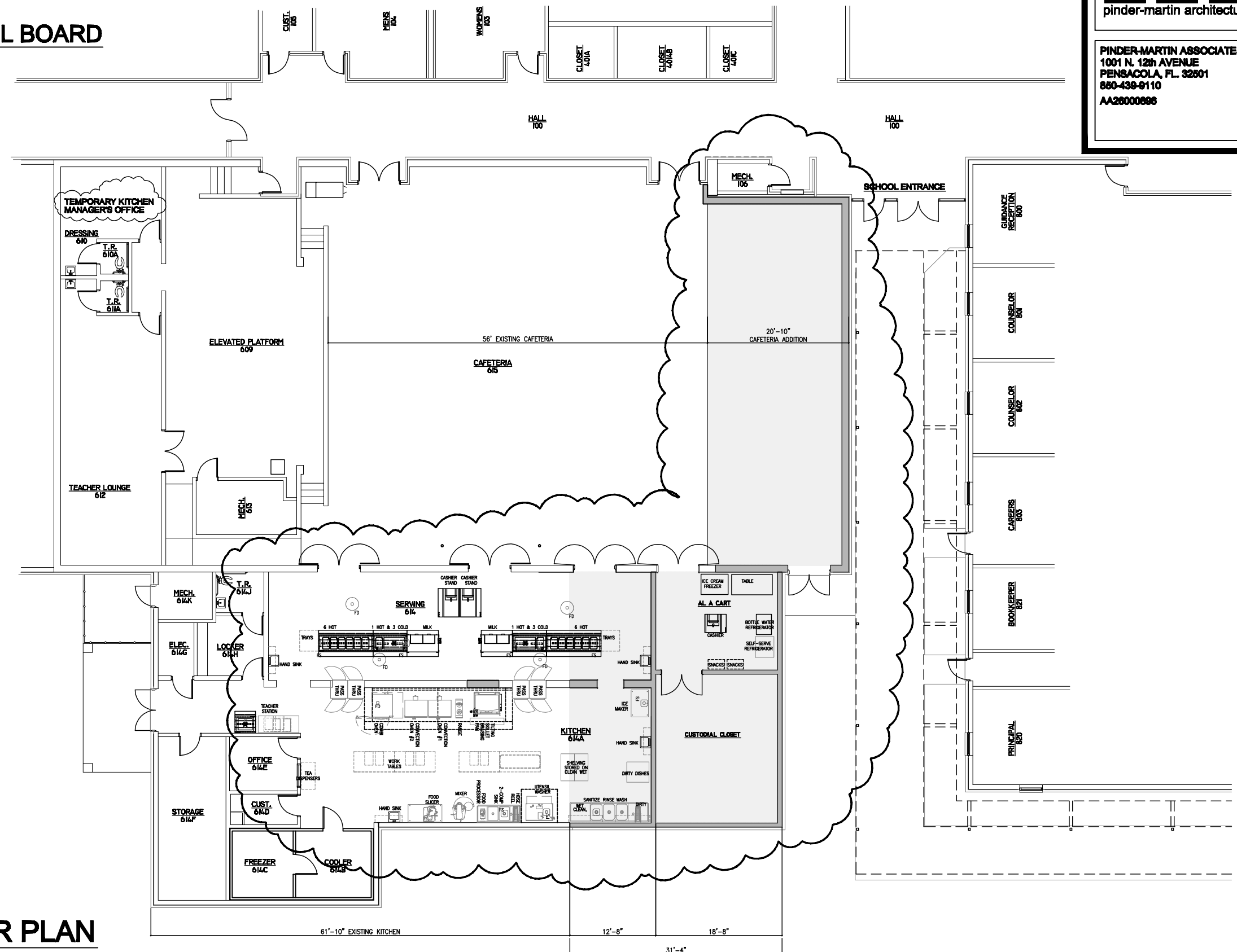

## Phase II NEW WORK FLOOR PLAN



03-02-15

**SANTA ROSA COUNTY SCHOOL BOARD**



# Holley-Navarre Middle School

## CAFETERIA/KITCHEN EXPANSION

### FOR THE SANTA ROSA COUNTY SCHOOL BOARD



PINDER-MARTIN ASSOCIATES, INC.  
1001 N. 12th AVENUE  
PENSACOLA, FL. 32501  
850-438-9110  
AA28000896

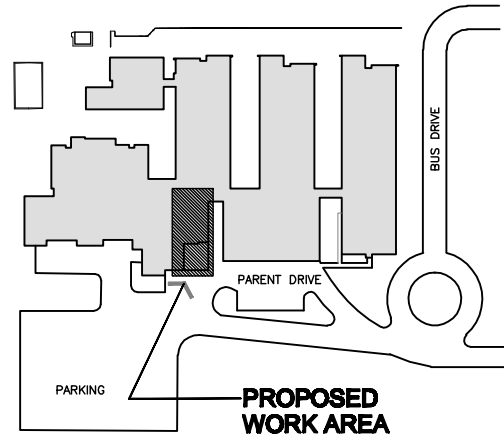

KEY PLAN

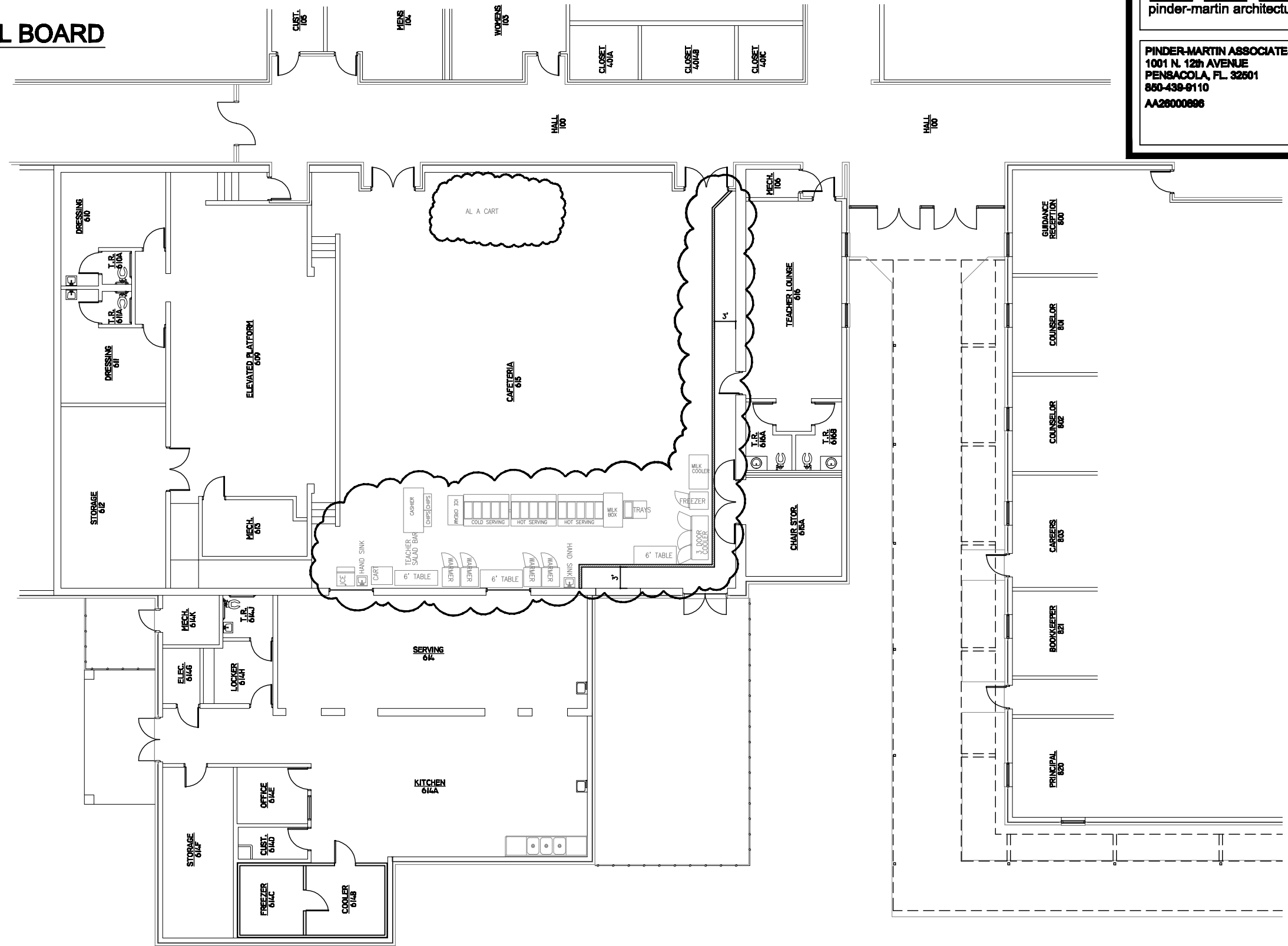

## Phase II TEMPORARY SERVING LINE

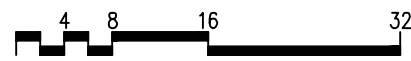

03-02-15