

Gulf Breeze Middle School

KITCHEN / CAFETERIA EXPANSION

FOR THE

SANTA ROSA COUNTY SCHOOL BOARD



PINDER-MARTIN ASSOCIATES, INC.
1001 N. 12th AVENUE
PENSACOLA, FL. 32501
850-439-9110
AA28000896

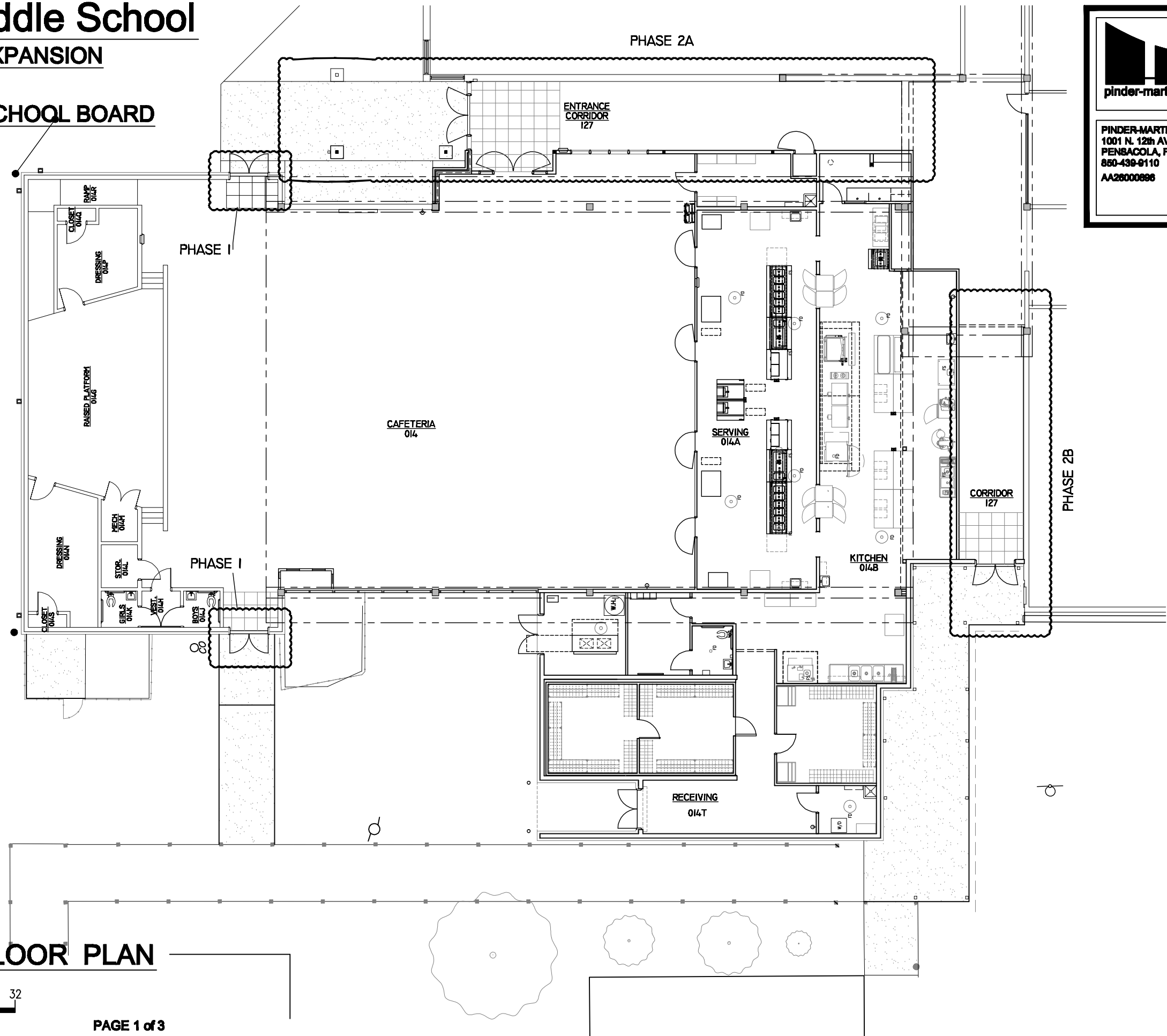
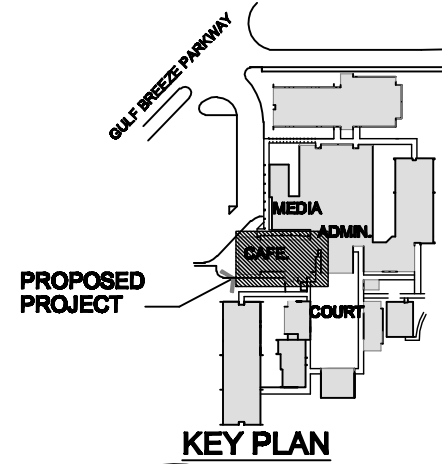

Phase III

NEW WORK FLOOR PLAN

0 4 8 16 32

03-02-15

Gulf Breeze Middle School

KITCHEN / CAFETERIA EXPANSION

FOR THE

SANTA ROSA COUNTY SCHOOL BOARD



PINDER-MARTIN ASSOCIATES, INC.
1001 N. 12th AVENUE
PENSACOLA, FL. 32501
850-439-9110
AA26000896

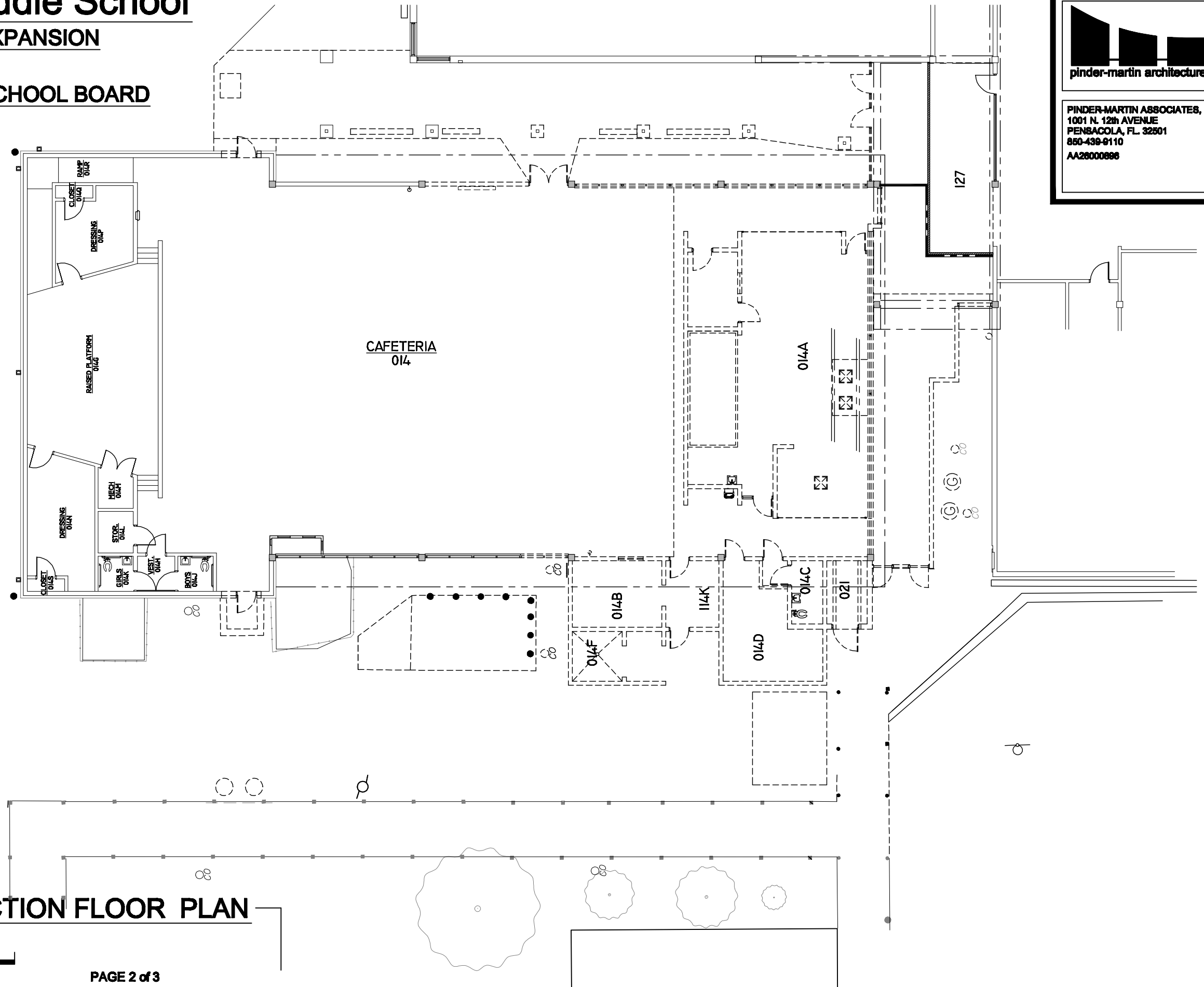
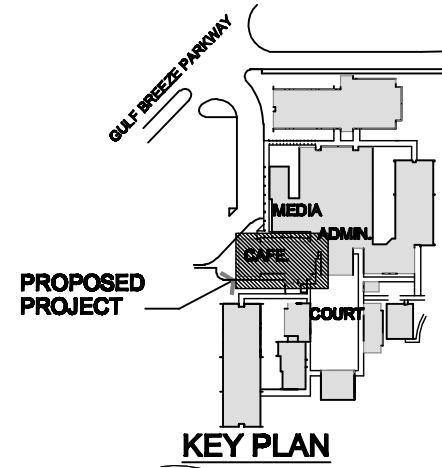

Phase III

DECONSTRUCTION FLOOR PLAN

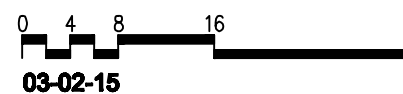

Gulf Breeze Middle School

KITCHEN / CAFETERIA EXPANSION

FOR THE

SANTA ROSA COUNTY SCHOOL BOARD



PINDER-MARTIN ASSOCIATES, INC.
1001 N. 12th AVENUE
PENSACOLA, FL. 32501
850-439-8110
AA26000886

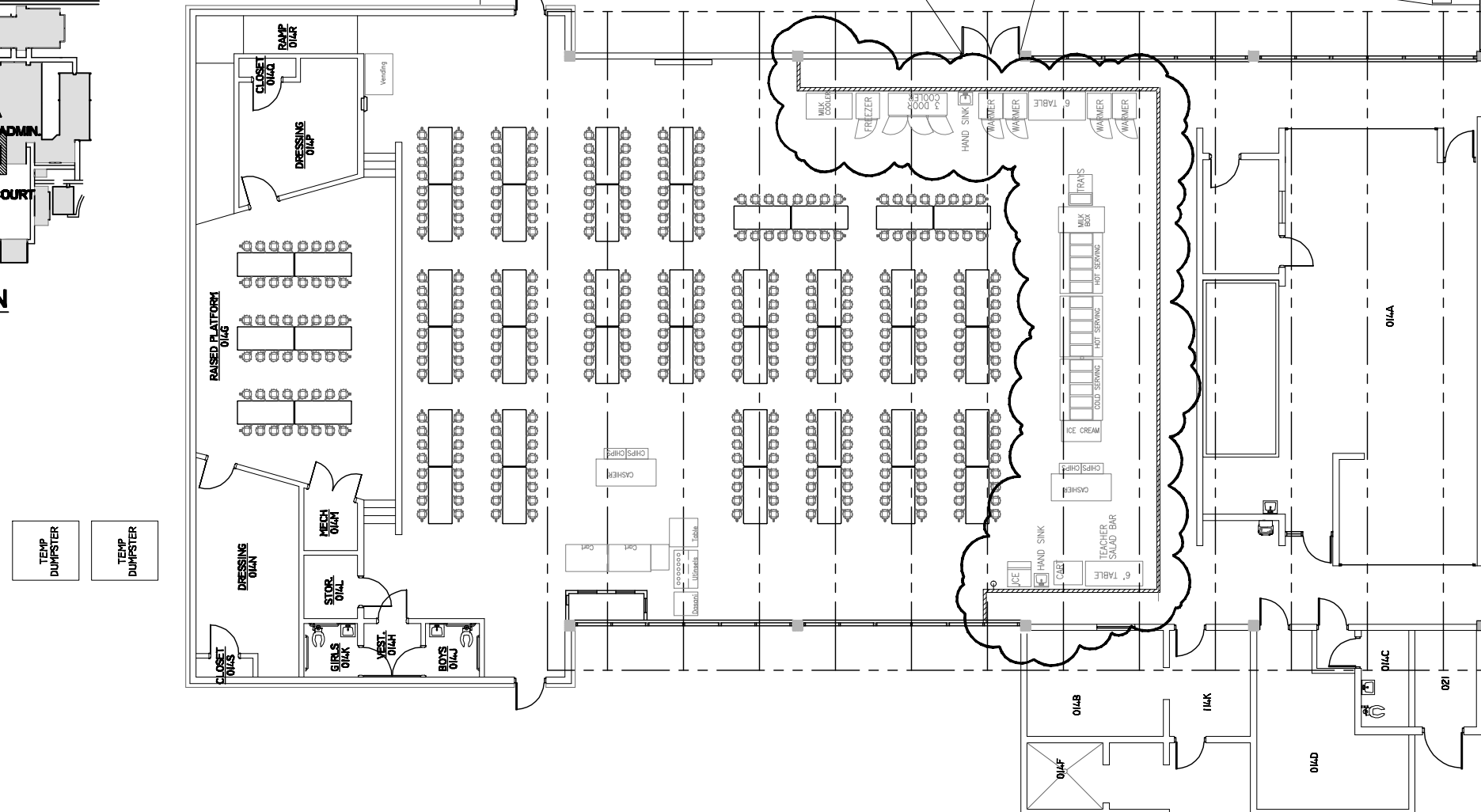
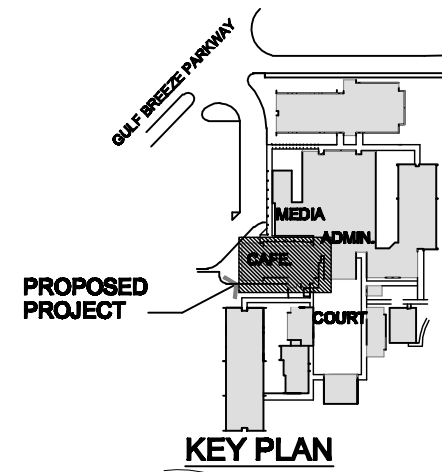

Phase III

TEMPORARY SERVING LINE

